



£395,000

West Street, Chatteris, Cambridgeshire PE16 6HA



To arrange a viewing call us now on 01354 694900

Offering an abundance of space, this five bedroom DETACHED family home offers versatility throughout and has enough parking to cater for the whole family! EXTENDED over the years, this SUBSTANTIAL property has three reception rooms, modern kitchen/diner with utility in support plus has the convenience of a ground floor WC. Upstairs there are four double bedrooms, one single, two en-suite shower rooms plus a family bathroom.

Viewing is highly recommended.

ellis winters 20 Market Hill, Chatteris, Cambridgeshire, PE16 6BA  
Tel: 01354 694900 Email: [info@elliswinters.co.uk](mailto:info@elliswinters.co.uk) [www.elliswinters.co.uk](http://www.elliswinters.co.uk)

**ellis winters**  
sales & lettings since 2001



**ellis winters**  
sales & lettings since 2001



£395,000

West Street, Chatteris, Cambridgeshire PE16 6HA

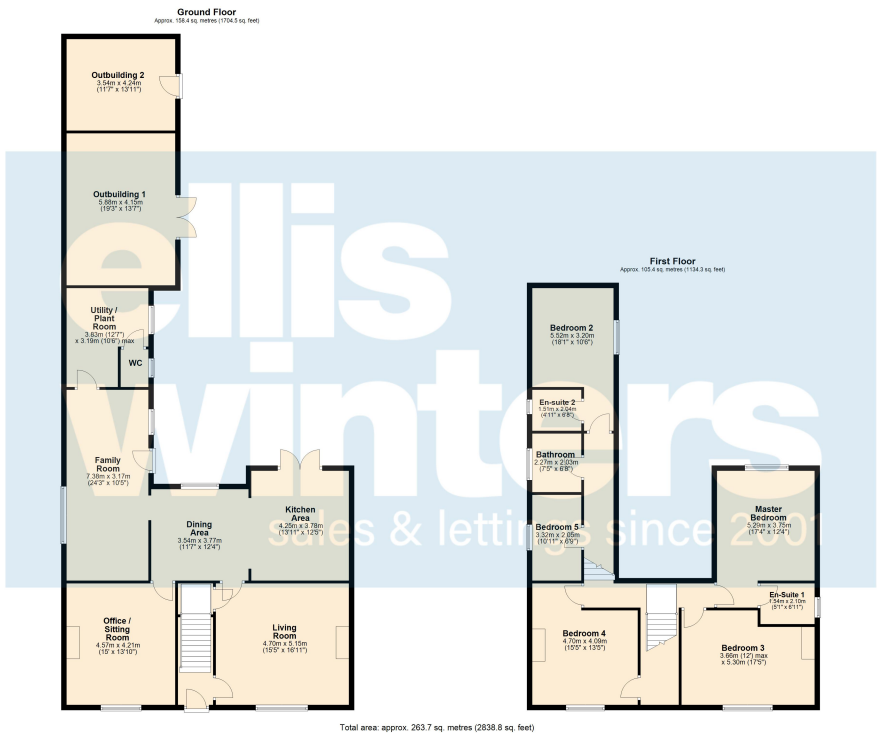

GROUND FLOOR

Living Room  
5.15m (16'11") x 4.70m (15'5")  
Window to front, fireplace housing woodburning stove, spacious under stairs cupboard.

Kitchen Area  
4.25m (13'11") x 3.78m (12'5")  
Fitted with a modern range of wall and base units housing eye level double electric oven and microwave, ceramic hob set within a central island which has extractor over, integrated dishwasher, double doors out to rear garden.

Dining Area  
3.77m (12'4") x 3.54m (11'7")  
Open plan to kitchen with window to rear.

Office/Sitting Room  
4.57m (15') x 4.21m (13'10")  
Window to front.

Family Room  
7.38m (24'3") x 3.17m (10'5")  
Two windows to side, door out to garden.

Utility/Plant Room  
3.83m (12'7") x 3.19m (10'6") max.  
Plumbing for washing machine and space for tumble drier, gas boiler and associated equipment. Window to side.

WC  
Fitted with a low level WC and hand wash basin. Window to side.

FIRST FLOOR

Master Bedroom  
5.29m (17'4") x 3.75m (12'4")  
Window to rear.

En-Suite 1  
2.10m (6'11") x 1.54m (5'1")  
Fitted with a double shower cubicle, low level WC and hand wash basin. Window to side.

Bedroom 2  
5.52m (18'1") x 3.20m (10'6")  
Window to side.

En-Suite 2  
2.04m (6'8") x 1.51m (4'11")  
Fitted with a single shower cubicle, low level WC and hand wash basin.

Bedroom 3  
5.30m (17'5") x 3.66m (12') max.  
Window to front, original fireplace.

Bedroom 4  
4.70m (15'5") x 4.09m (13'5")  
Window to front.

Bedroom 5  
3.32m (10'11") x 2.05m (6'9")  
Window to side.

Bathroom  
2.27m (7'5") x 2.03m (6'8")  
Fitted with a feature bath, low level WC and hand wash basin. Window to side.

OUTSIDE

There is a vast enclosed parking area to one side of the property and to the other double gates lead into the rear garden where there is additional parking if required.

The garden to the rear is laid mainly to lawn, with patio area and shrub border. There are two outbuildings which require some TLC.

Outbuilding 1  
5.88m (19'3") x 4.15m (13'7")

Outbuilding 2  
4.24m (13'11") x 3.54m (11'7")

SERVICES  
Mains gas, electricity, water and drainage.  
The property as gas fired central heating.

TENURE  
Freehold

Fenland District Council Tax band E  
Energy rating D

Buyer ID Checks  
To meet legal requirements, we must verify the identity of all buyers. Our partner, Simplify, will handle this process and will contact you directly once your offer is accepted, subject to contract, to collect the necessary details and payment. The cost is £49 + VAT per transaction, payable upon offer acceptance. A memorandum of sale can only be issued once these checks are complete.

Our team will guide you through the process when you make an offer on a property.

Disclaimer  
All property details, photographs, floorplans, and other marketing materials produced by Ellis Winters are for general guidance only and do not form part of any contract. While we strive for accuracy, measurements, descriptions, and other information are provided in good faith but should be independently verified. We recommend that prospective buyers conduct their own due diligence before making any decisions.