



22 The Willows Manor Farm Court, Selsey

Guide Price £150,000

22 The Willows Manor Farm Court

Selsey, Chichester

Nestled within a popular retirement complex, this charming cottage offers a tranquil retreat for those seeking a peaceful and secure community living environment.

The accommodation comprises:- Living Room overlooking duck pond, kitchen, a double bedroom complete with a built-in wardrobe. A first-floor bathroom and a convenient ground floor cloakroom ensure practicality and ease of use.

This property is equipped with pull cords in each room, offering reassurance that assistance is readily available if needed and an onsite manager.

Residents can take advantage of the communal facilities, including a lounge area for social gatherings and activities, as well as guest accommodation for visiting friends and family. Parking is available on a first-come, first-served basis, providing convenience for residents with vehicles.

Council Tax: B, Leasehold, EPC: F

- Retirement cottage in popular complex
- Double bedroom with built in wardrobe
- 1st floor bathroom and ground floor cloakroom
- Living room with view over the duck pond
- Kitchen with view over communal gardens
- Onsite manager & pull cords in each room
- Communal lounge and guest bedroom.
- Parking on a 1st come 1st served basis



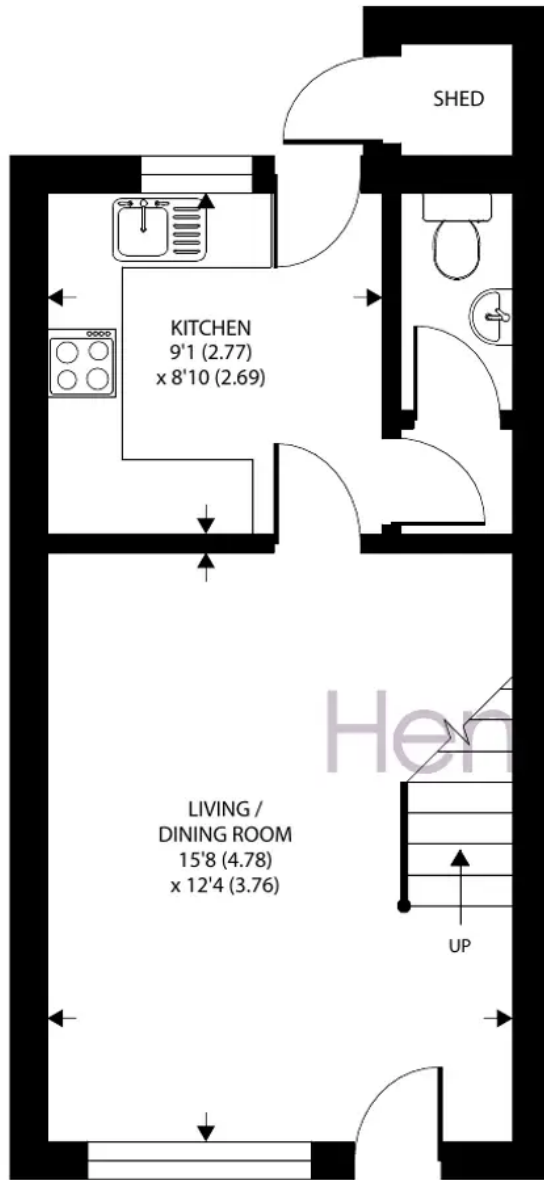

GROUND FLOOR



FIRST FLOOR



Henry Adams
estate agents

Approximate Area = 566 sq ft / 52.6 sq m (includes shed)

For identification only - Not to scale





Henry Adams - Selsey

Henry Adams LLP, 122 High Street, Selsey - PO20 0QE

01243 606789

selsey@henryadams.co.uk

www.henryadams.co.uk/

Agents Note - Our particulars are for guidance only and are intended to give a fair overall summary of the property. They do not form part of any contract or offer, and should not be relied upon as a statement or representation of fact. Measurements, areas and distances are approximate only. Photographs may include lifestyle shots and pictures of local views. No undertaking is given as to the structural condition of the property, or any necessary consents or the operating ability or efficiency of any service, system or appliance. Please ask if you would like further information, especially before you travel to the property.