





Uplands, 17 West Close, Middleton-on-Sea

Beautifully presented three double bedroom character family home.



- ▶ **Detached Character House**
- ▶ **Private Estate**
- ▶ **Dining Room**
- ▶ **Study**
- ▶ **Double Garage and Parking**

- ▶ **Refitted Bathroom and Shower Room**
- ▶ **Sitting Room**
- ▶ **Kitchen/Breakfast Room**
- ▶ **Three Bedrooms**
- ▶ **Vacant Possession**

A charming three double bedroom detached house situated on an elevated position on the highly desirable Sea Lane Estate in Middleton-on-Sea and less than 400 yards from the beach.

The well proportioned accommodation includes an entrance hall with attractive original oak parquet flooring, spacious kitchen/breakfast room with doors leading out to the garden, a dual aspect sitting room, dining room overlooking the garden, study and recently refitted ground floor shower room/WC.

On the first floor, three double bedrooms can be found along with a remodelled and refitted bathroom/WC.

Outside, to the front of the property is a five bar gate which opens to a driveway leading to a detached double garage with an electric door. There is also a lawned area and recently laid patio to the front. The rear garden is of a westerly aspect and enjoys seclusion.

Estate Charge: TBC

Council Tax Band: F







APPROX. GROSS INTERNAL FLOOR AREA 2064 SQ FT 191.7 SQ METRES (EXCLUDES SUMMER HOUSE & INCLUDES GARAGE)

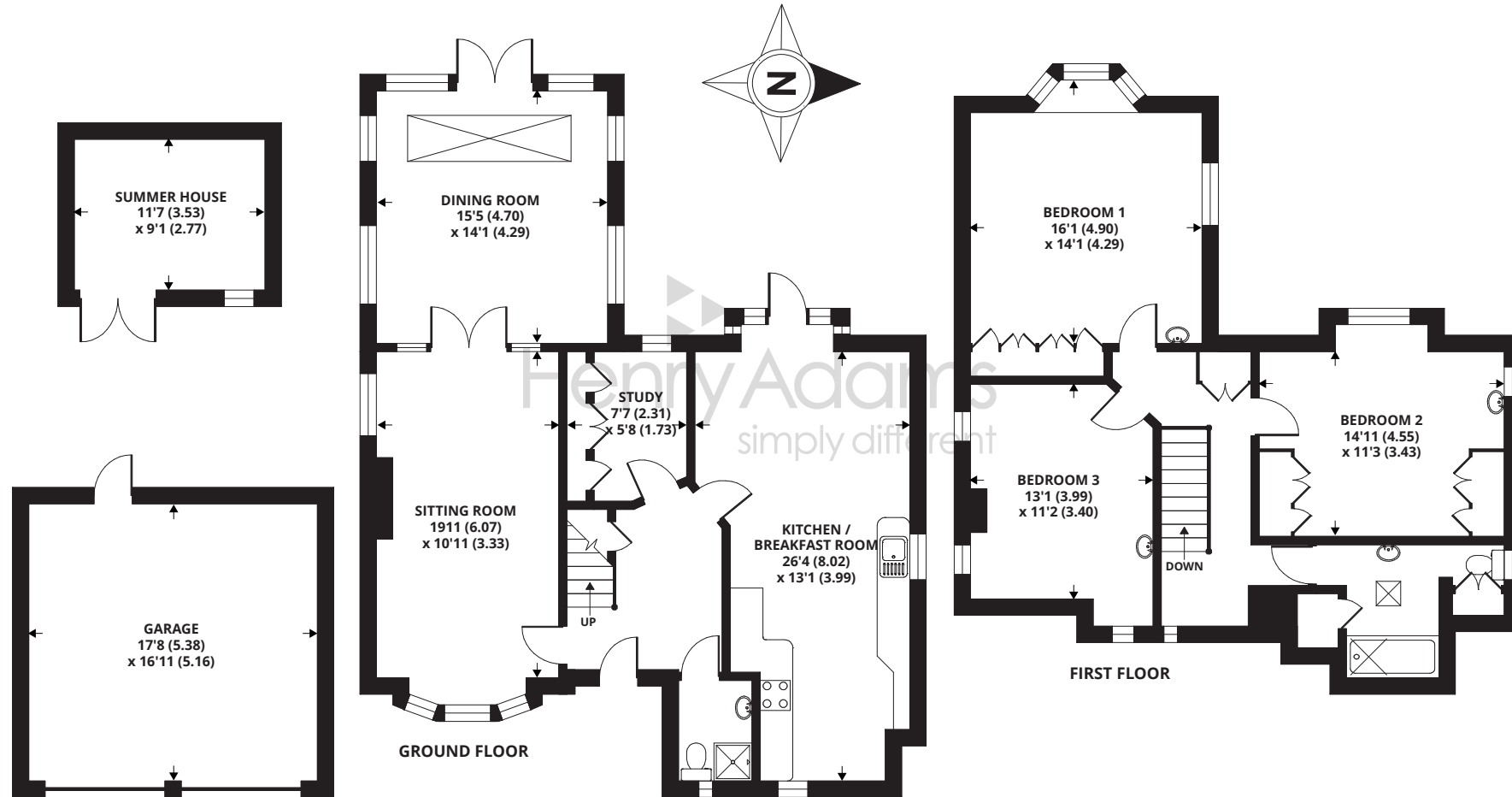

Agents Note - Our particulars are for guidance only and are intended to give a fair overall summary of the property. They do not form part of any contract or offer, and should not be relied upon as a statement or representation of fact. Measurements, areas and distances are approximate only. Photographs may include lifestyle shots and pictures of local views. No undertaking is given as to the structural condition of the property, or any necessary consents or the operating ability or efficiency of any service, system or appliance. Please ask if you would like further information, especially before you travel to the property.

Location

The charming village of Middleton-on-Sea offers a wide range of local facilities including a doctors surgery, pharmacy, sports/social club, post office and a range of useful shops. Nearby attractions include Bognor Regis Golf Club, a sailing club and the unspoilt beach. Historic Arundel, the cathedral city of Chichester and the famous Goodwood motor circuit and racecourse can all be found within an 11 mile radius.

Directions

From our office in Middleton-on-Sea bear right and take the first turning on the right into Sea Lane. After approximately 200 yards turn right into South Walk and continue to the end of the road. At the junction turn left into West Close where the property will be found after a short distance on the right.

20/02/24

