

## Royal Arch Court, Earlham Road, Norwich. NR2 3RU

Offers In Region Of £195,000

1 1 1



Moneyproperties presents this charming one bedroom apartment offering picturesque views of the impressive St Johns Cathedral. Situated in the heart of Norwich, this property provides convenient access to all the city has to offer. This apartment, located in the Royal Arch Court complex, features a spacious 23ft living room with stunning Cathedral views, a well-equipped kitchen, a spacious bedroom with built-in wardrobes, a modern bathroom, and an airing/store cupboard. Residents of Royal Arch Court enjoy the benefits of a secure gated complex with a Court manager, residents lounge, laundry facilities, and beautiful gardens.

**Tenure: Leasehold EPC: TBC Council Tax: B**

## Key Features

- Secure gated complex with a Court manager offering one bedroom
- Offering approximately 550 sq ft of living space
- Close to the City centre with all its amenities
- Parking for visitors
- Owner must be over 60 years of age, second owner can be 55 years.
- Impressive views of St Johns Cathedral Norwich
- Residents have access to laundry, function room and gardens
- Regular bus and rail services
- No Forward chain / quick sale possible
- See our full online listing for further details including flood risk, broadband speed and other material information.

GROUND FLOOR

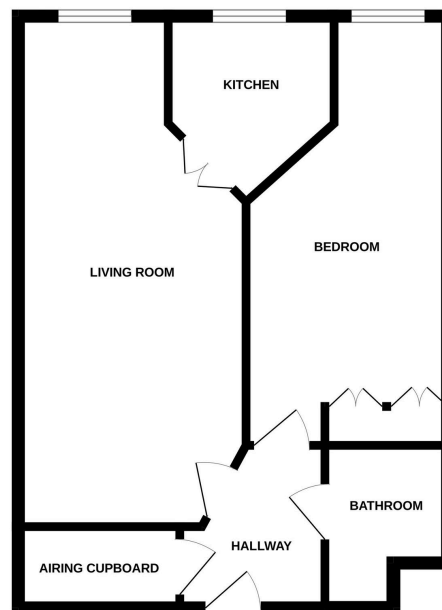

Whilst every attempt has been made to ensure the accuracy of the floorplan contained here, measurements of doors, windows, rooms and any other items are approximate and no responsibility is taken for any error, omission or mis-statement. This plan is for illustrative purposes only and should be used as such for any prospective purchase. The services, systems and appliances shown have not been tested and no guarantee as to their operability or efficiency can be given.  
Made with Metropix 12/2025