

Lime Tree Avenue, Wymondham, Norfolk

Offers In Region Of £315,000

3 1 2



Moneyproperties are delighted to present this beautifully renovated three bedroom detached bungalow, ideally situated on the sought after Lime Tree Avenue, close to local shops, local schools with GOOD and EXCELLENT ofsted reports, and regular bus services to Norwich. The property has been thoughtfully modernised including installation of gas central heating, an ultra modern kitchen with integrated fridge/freezer, dishwasher, electric oven and hob, a stylish bathroom finished with contemporary tiled floors and walls. A standout feature is the 18ft living room, with bifold doors opening onto a generous 30ft x 30ft rear garden.

Tenure: Freehold EPC:E Council Tax: C

Key Features

- Beautifully renovated detached three bedroom bungalow
- Ultra modern kitchen with breakfast bar and stools
- Parking to the front of the bungalow for 2/4 cars
- New central heating system including radiators
- Rear garden with two patio areas and lawn area
- Offering approximately 800 sq ft of living space
- Modern bathroom with tiled floors and walls
- Single garage to the rear of the property with further parking
- 18ft living room with bi fold doors connecting the indoors with the outdoors
- See our full online listing for further details including flood risk, broadband speed and other material information.

GROUND FLOOR

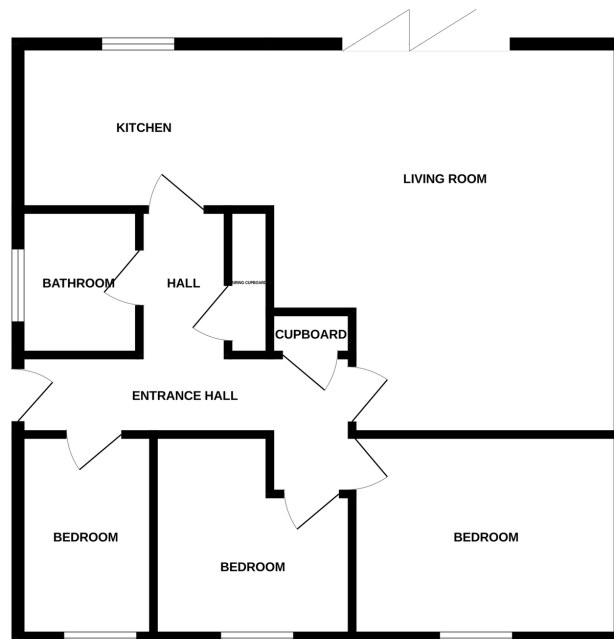

Whilst every attempt has been made to ensure the accuracy of the floorplan contained here, measurements of doors, windows, rooms and any other items are approximate and no responsibility is taken for any error, omission or mis-statement. This plan is for illustrative purposes only and should be used as such by any prospective purchaser. The services, systems and appliances shown have not been tested and no guarantee as to their operability or efficiency can be given.
Made with Metreplex C2025