

## Bellrope Lane, Wymondham, Norfolk

Offers In Region Of £575,000

4 2 3



Spacious 4/5 Bedroom Detached Bungalow on Generous 0.25 Acre Plot in Sought-After Historic Wymondham. Situated on the popular Bellrope Lane and within easy walking distance of Wymondham High Academy (Ofsted: GOOD) and all Wymondham's three Primary Schools, this impressive detached 4/5 bedroom bungalow occupies a substantial 180ft x 60ft (0.25 acre) plot, offering excellent scope for further development (subject to the necessary planning consents). The flexible and well-proportioned accommodation offers approximately 2100 sq ft of living space.

**Tenure: Freehold EPC: C Council Tax: C**

## Key Features

- Spacious 4/5 Bedroom Detached Bungalow on Generous 0.25 Acre Plot
- Offering approximately 2100 sq ft of living space with potential for more
- Further extension to provide two further bedrooms and bathroom / annexe potential
- 25 ft Garage / worksop and drive way parking for 7/8 cars comfortably
- Walking distance from all Primary Schools and sought after Wymondham High with GOOD ofsted
- Located in a quiet cul de sac in Sought-After Historic Wymondham
- Extended to provide outstanding 25ft Kitchen with appliances and Island
- Kitchen and Conservatory lead into the rear garden so ideal for entertaining
- Ideally located for all that this Historic Norfolk Market Town has to offer
- See our full online listing for further details including flood risk, broadband speed and other material information

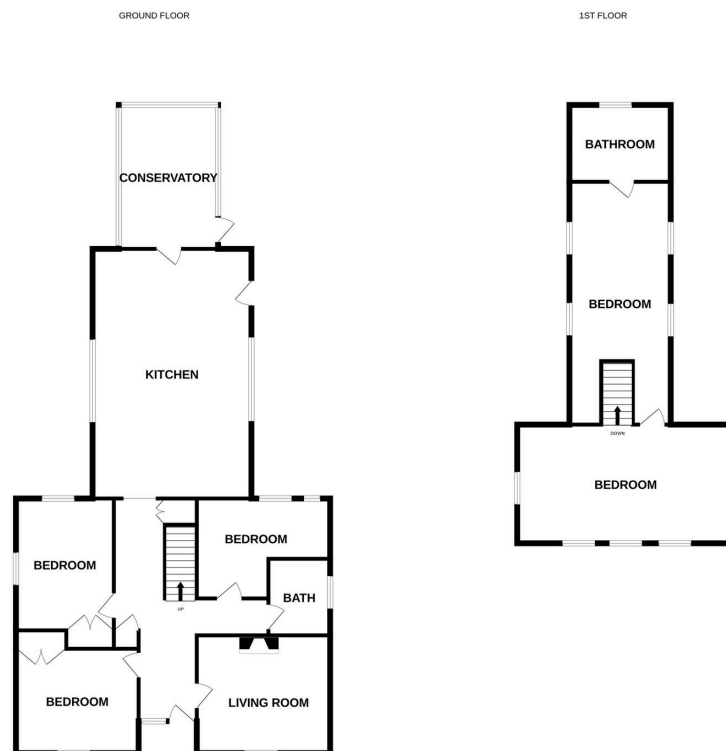

Whilst every attempt has been made to ensure the accuracy of the floorplan contained here, measurements of doors, windows, rooms and any other items are approximate and no responsibility is taken for any error, omission or mis-statement. This plan is for illustrative purposes only and should be used as such by any prospective purchaser. The services, systems and appliances shown have not been tested and no guarantee as to their operability or efficiency can be given.  
Made with Mettler CX2025