

Yesmere, Mulbarton, NR14

£255,000

3 1 2

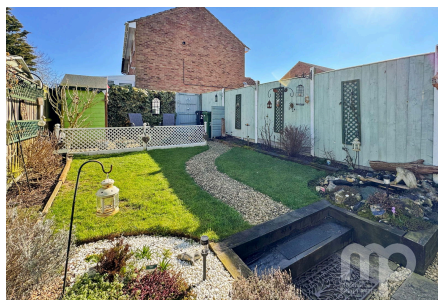
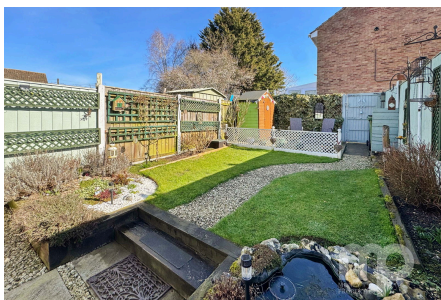

Moneyproperties bring to market this well-presented three-bedroom terraced home located down a quiet cul de sac in the popular village of Mulbarton. Within ease of access to local amenities, bus routes and Norwich city centre the accommodation comprises of an entrance porch, 15ft living room, modern kitchen/diner, and generous conservatory/garden room. To the upstairs comes three bedrooms with built in wardrobes to bedroom one and two along with a family bathroom. Outside the property enjoys an idyllic landscaped rear garden, en bloc garage and parking to the front of the garage.

Tenure: Freehold EPC: C Council Tax: B

Key Features

- Well-presented three bedroom terraced house
- Three well-proportioned bedrooms
- Generous conservatory overlooking the rear garden
- Idyllic landscaped rear garden
- Must be viewed to fully appreciate
- Located down a quiet cul de sac
- Modern kitchen/diner
- Within ease of access to local amenities, bus route and Norwich city centre
- En bloc garage with off-road parking
- See our full online listing for further details including flood risk, broadband speed and other material information.

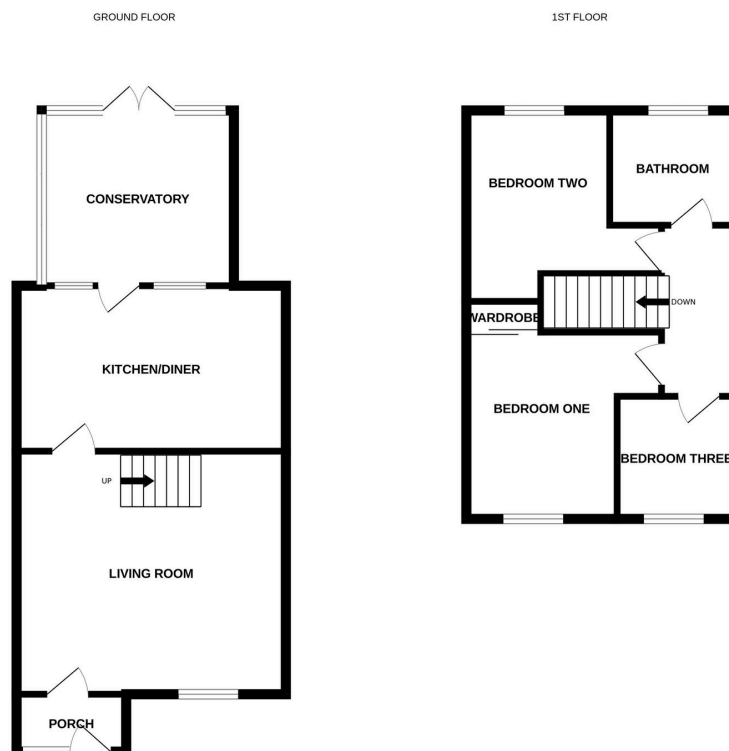

Whilst every attempt has been made to ensure the accuracy of the floorplan contained herein, measurements of doors, windows, rooms and any other items are approximate and no responsibility is taken for any error, omission or mis-statement. This plan is for illustrative purposes only and should be used as such by any prospective purchaser. The services, systems and appliances shown have not been tested and no guarantee as to their operability or efficiency can be given.
Made with Metreapp ©2025