



Lime Tree Avenue, Wymondham, NR18

£120,000

 1  1  1



Moneyproperties bring to market this one-bedroom apartment close to local amenities and the town centre. This first floor apartment is being offered with a tenant in-situ and is a perfect purchase for investors and landlords looking to grow their portfolio. The accommodation comprises of an entrance hall with closet, 13ft 9in living room, fitting kitchen, bedroom, and bathroom. There is off road parking and the property is well placed for local and town centre amenities, has easy access to the main A11 for commuting to Norwich and Cambridge for work.

Tenure: Leasehold EPC: D Council Tax: A

Key Features

- One bedroom first floor apartment
- Modern fitted kitchen
- Allocated parking
- Close to local shops/bus routes
- Being sold with a tenant in-situ
- Perfect purchase for investors and landlords looking to grow their portfolio
- 13ft 9in living room
- Offering approximately 460 sq ft of living space
- Easy access to the main A11 for commuting
- See our online listing for further details including flood risk, broadband speed and other material information

GROUND FLOOR

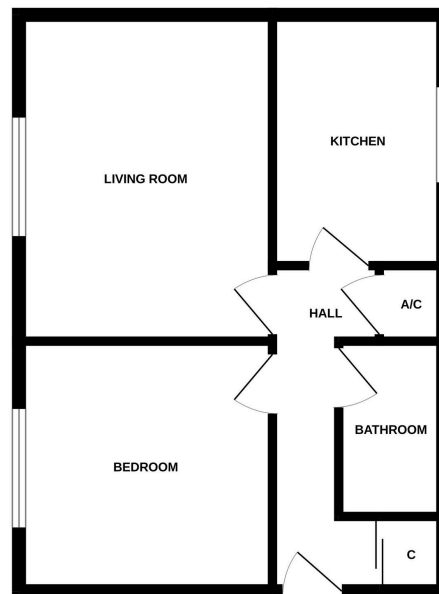

Whilst every attempt has been made to ensure the accuracy of the floorplan contained here, measurements of doors, windows, rooms and any other items are approximate and no responsibility is taken for any error, omission or mis-statement. This plan is for illustrative purposes only and should be used in such by any prospective purchaser. The services, systems and appliances shown have not been tested and no guarantee as to their operability or efficiency can be given.
Made with Metropix 02/24