

Kings Park, Dereham

Guide Price £200,000

3 1 1



GUIDE PRICE £200,000-£225,000 Moneyproperties present this semi detached three bedroom bungalow in need of updating hence price with no forward chain so a quick sale would be possible. This three bedroom semi detached bungalow offers approximately 850 sq ft of livings space and comprises of entrance hall, 15ft 7in living room, kitchen, shower room, three bedrooms and a conservatory off bedroom three, the property sits on a 85ft x 35ft plot with a 30ft front garden, garage en bloc and a 25ft rear garden, the property is in need of updating and would benefit from having a new kitchen and bathroom.

Tenure: Freehold EPC: C Council Tax: B

Key Features

- Semi detached three bedroom bungalow, double glazing installed
- Offering approximately 850 sq ft of living space
- Sitting on a generous plot 85ft x 35ft with Garage en-block
- Quiet cul de sac location with similar type bungalows
- Walking distance from the town centre with all its amenities
- Close to sought after schools and supermarkets
- Easy access to the main A47 for those commuting to Norwich and Cambridge
- In need of some updating hence the price
- No forward chain / quick sale possible
- See our online listing for further details including flood risk, broadband speed and other material information

GROUND FLOOR

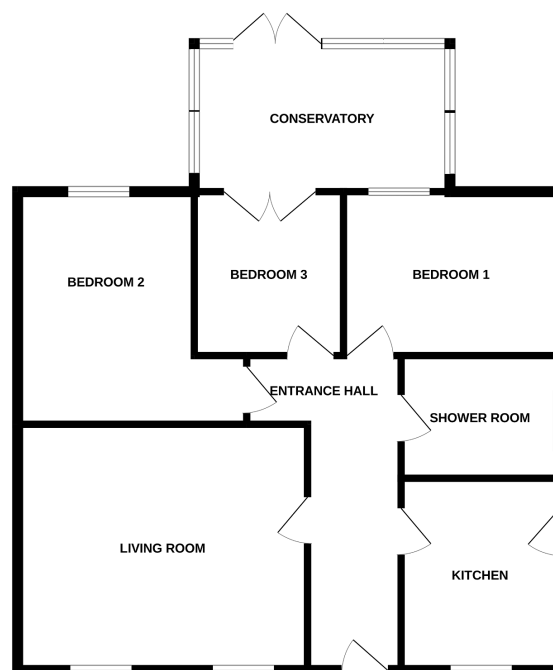

Whilst every attempt has been made to ensure the accuracy of the floorplan contained here, measurements of doors, windows, rooms and any other items are approximate and no responsibility is taken for any error, omission or misstatement. This plan is for illustrative purposes only and should be used in such by any prospective purchaser. The services, systems and appliances shown have not been tested and no guarantee as to their operability or efficiency can be given.
Made with Metropix ©2023