



May Street , Snodland ME6 5AZ

- Three Bedroom Victorian Terraced Home
- Walking Distance To High Speed Snodland Train Station
- Through Lounge / Diner
 - Ideal First Time Buy
- GUIDE PRICE: £225,000-£245,000
- Good Sized Rear Garden
- Outside Office With Electricity
- READY TO VIEW NOW!
 - On Road Parking

Price Guide £225,000 Freehold

Local Authority
Council Tax Band B
EPC Rating D

May Street, Snodland, ME6

Approximate Area = 712 sq ft / 66.1 sq m

Outbuilding = 131 sq ft / 12.1 sq m

Total = 843 sq ft / 78.2 sq m

For identification only - Not to scale

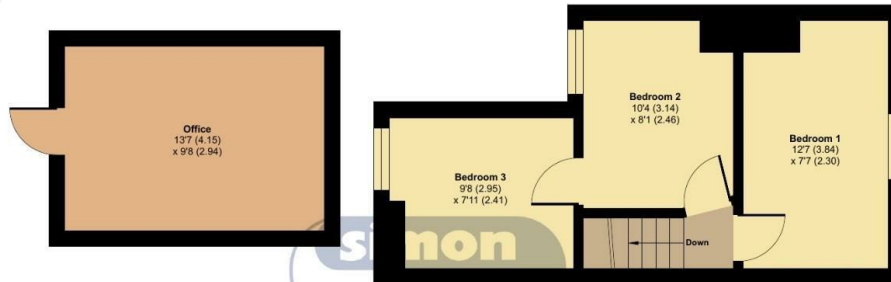

FIRST FLOOR

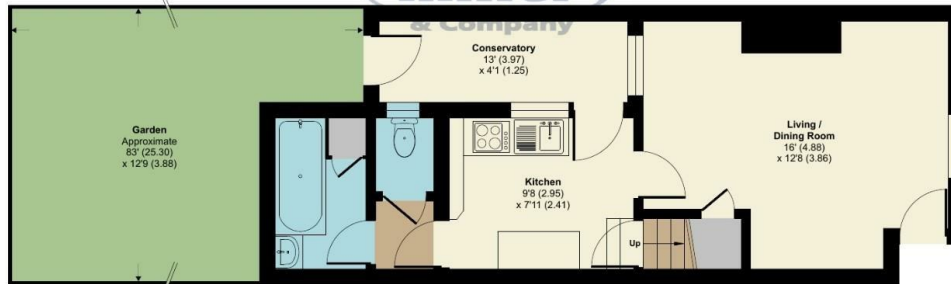

GROUND FLOOR



Floor plan produced in accordance with RICS Property Measurement Standards incorporating International Property Measurement Standards (IPMS2 Residential). © richcom 2024. Produced for Simon Miller & Company. REF: 1104636

Malling Office

777 London Road, Larkfield, Aylesford,
Kent, ME20 6DE

Contact

01732 875706
larkfieldsales@simonmiller.co.uk
<https://simonmiller.co.uk/>

Agents Note: Whilst every care has been taken to prepare these particulars, they are for guidance purposes only. All measurements are approximate and for general guidance purposes only and whilst every care has been taken to ensure accuracy, they should not be relied upon and potential buyers/tenants are advised to recheck the measurements.

