

**4 HAYFIELD ROAD EAST**  
 Chapel-En-Le-Frith  
**£145,000**

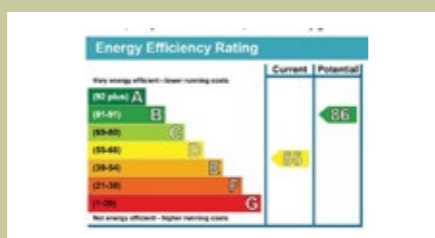
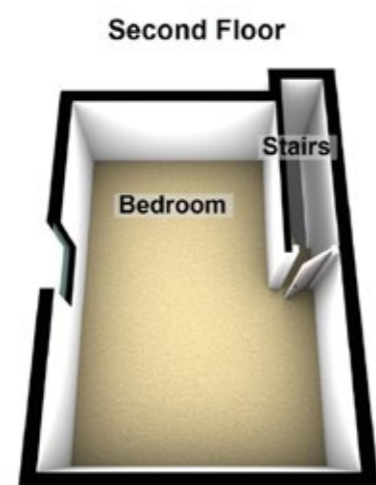
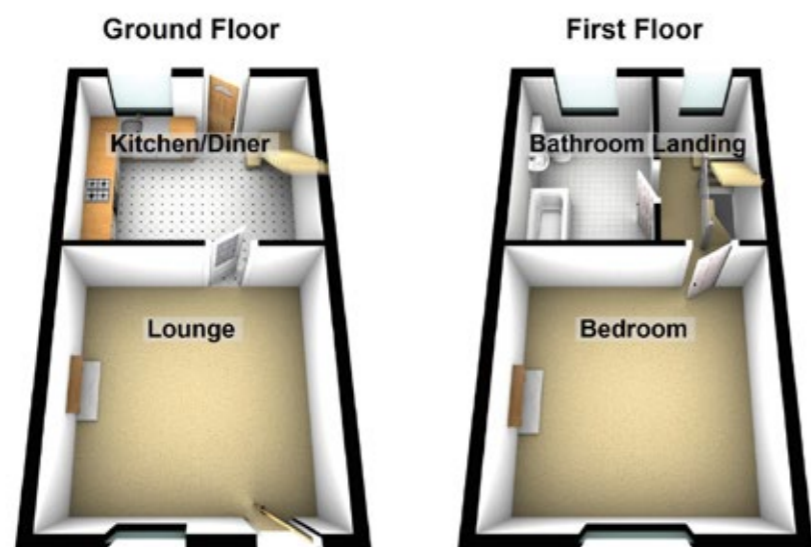

**NOTICE**  
 Gascoigne Halman for themselves and for the vendors or lessors of this property whose agents they are give notice that: (i) the particulars are set out as a general outline only for the guidance of intending purchasers or lessees, and do not constitute, nor constitute part of, an offer or contract; (ii) all descriptions, dimensions, references to condition and necessary permissions for use and occupation, and other details are given in good faith and are believed to be correct but any intending purchasers or tenants should not rely on them as statements or representations of fact but must satisfy themselves by inspection or otherwise as to the correctness of each of them; (iii) no person in the employment of Gascoigne Halman has any authority to make or give any representation or warranty whatever in relation to this property.

THE AREAS LEADING ESTATE AGENCY

Chapel-En-Le-Frith

27 Market Street, CHAPEL-EN-LE-FRITH, High Peak SK23 0HP

01298 813577 chapel@gascoignehalman.co.uk

gascoignehalman.co.uk



**GASCOIGNE HALMAN**

A spacious two double bedroom property set over three floors. Close to local shops and amenities.



- Central Location
- Close To Local Shops and Amenities

- No Chain

£145,000

4 HAYFIELD ROAD EAST

Chapel-En-Le-Frith



A spacious two double bedroom property set over three floors. Close to local shops and amenities.

**LOCATION**

Chapel-en-le-Frith, known as 'The Capital of the Peak' nestles in an upland valley in the High Peak and is surrounded by dramatic landscape of gritstone ridges and shapely hills. The town takes its name from a small chapel built in 1225 by the keepers of the Royal Forest that is now the Church of St Thomas Becket, where 1,500 Scottish soldiers were imprisoned during the Civil War. The historic town center also features a traditional marketplace which still has its original renowned stocks which the local cafe takes its name. A common phrase you here many resident say is "We are so lucky to live here" even after living in the town for decades. That is further, solid evidence, if ever it was needed that Chapel-en-le-Frith and its

surrounding town and villages is an excellent place to set up home.

**DIRECTIONS**

SK23 0JG in to your SAT NAV

**TENURE**

Subject to verification from your solicitors.

**SERVICES (NOT TESTED)**

Services have not been tested and you are advised to make your own enquiries and/or inspections.

**LOCAL AUTHORITY**

High Peak Borough Council. Council tax band: B

**POSTCODE**

SK23 0JG

**VIEWING**

Viewing strictly by appointment through the Agents.

TWENTY NETWORKED OFFICES THROUGHOUT CHESHIRE, SOUTH MANCHESTER & THE HIGH PEAK



gascoignealman.co.uk

GASCOIGNE HALMAN