

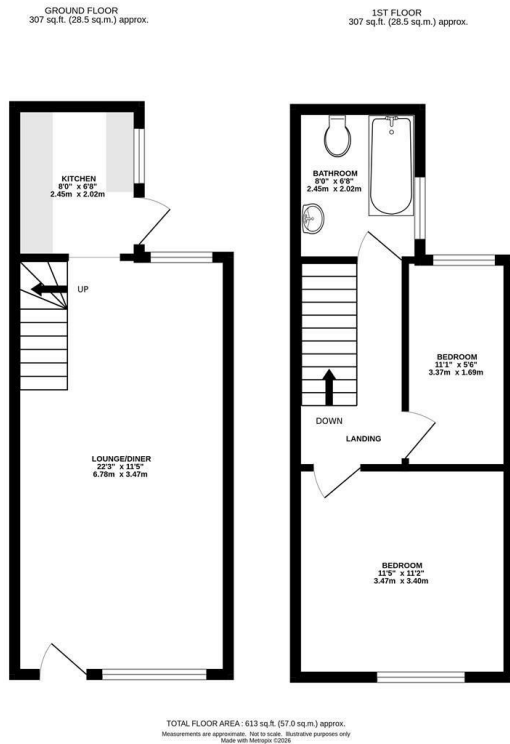

Keith
Ashton

Great Eastern Road, Warley
Brentwood



£365,000



41 Great Eastern Road, Warley, Brentwood, CM14 5EH

We are pleased to bring to market this two-bedroom mid-terrace cottage, ideally positioned just a stone's throw from Brentwood Station, offering excellent transport links into London and beyond.

Offered with no onward chain, the property presents a fantastic opportunity for buyers to modernise and personalise to their own taste. The accommodation includes a spacious lounge/diner, creating a flexible and welcoming living space, along with a private rear garden with back gate access.

Conveniently located within easy reach of Brentwood High Street, the property benefits from a wide selection of shops, bars and restaurants, making it perfectly suited for commuters, first-time buyers or investors alike.

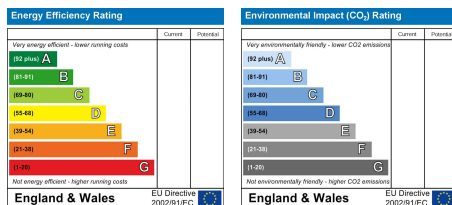

SERVICES:

Local Authority: Brentwood
Council tax band: C
Post code: CM14 5EH

VIEWING:

Strictly by prior arrangement with Keith Ashton Estate Agents

OPENING HOURS:

Monday to Friday: 8.45AM - 6.30PM | Saturdays: 9AM - 5.30PM | Sundays: 10AM - 2PM

MORTGAGE INFORMATION: We offer the additional facility of an in-house Independent Financial Adviser who will access all mortgage lenders with the purpose of providing you with the benefit of choice. For quotations or comparables please call 01277 260858 or visit our interactive website at www.mortgagebusiness.net



We the Agent have not tested any apparatus, fittings or services for this property. The plot size is intended merely as a guide and has not been officially measured or verified by the Agent. Photographs are for illustration only and may depict items which are not for sale or included in the sale of the property. As part of the service we offer we may recommend ancillary services to you which we believe may help you with your property transaction. We wish to make you aware, that should you decide to use these services we will receive a referral fee. For full and detailed information please visit 'terms and conditions' on our website www.keithashton.co.uk

Brentwood
Tel. 01277 260858

Village Office
Tel. 01277 375757

Lettings Office
Tel. 01277 202200

Explore more @ www.keithashton.co.uk

