



Keith  
Ashton

Gresham Close,  
Brentwood



FIRST FLOOR  
394 sq.ft. (36.6 sq.m.) approx.

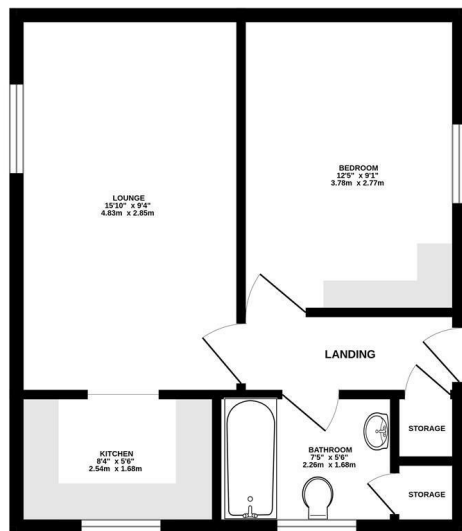

TOTAL FLOOR AREA: 394 sq.ft. (36.6 sq.m.) approx.  
Measurements are approximate. Not to scale. Illustrative purposes only.  
(Made with Metrege 1/2020)

Offers In Excess Of £220,000



## 7 Sovereign Court Gresham Close, Brentwood, CM14 4FY

\*\*\*NO ONWARD CHAIN\*\*\* Nestled in the charming area of Gresham Close, Brentwood, this delightful one-bedroom apartment presents an excellent opportunity for both first-time buyers and investors alike, being conveniently located near local amenities and transport links. Situated on the first floor, there is a generously sized double bedroom offering a peaceful retreat with fitted wardrobes and space for additional furnishings. The well stocked kitchen is designed to maximize space and gives direct access to the lounge area that is a bright and inviting space ideal for relaxing or entertaining, with ample room for seating and dining arrangements. There is a modern bathroom comprising a full-sized bathtub, toilet, and wash hand basin and ample storage accessed via the bathroom and landing area.

Externally, the property benefits from allocated parking, visitor parking as well as beautifully maintained communal gardens.

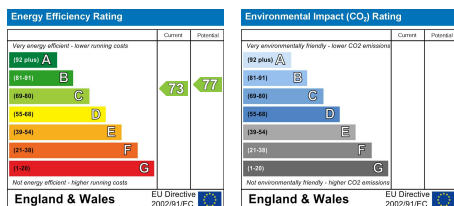

### SERVICES:

Local Authority: Brentwood  
Council tax band: C  
Post code: CM14 4FY

### VIEWING:

Strictly by prior arrangement with Keith Ashton Estate Agents

### OPENING HOURS:

Monday to Friday: 8.45AM - 6.30PM | Saturdays: 9AM - 5.30PM | Sundays: 10AM - 2PM

### MORTGAGE INFORMATION:

We offer the additional facility of an in-house Independent Financial Adviser who will access all mortgage lenders with the purpose of providing you with the benefit of choice. For quotations or comparables please call 01277 260858 or visit our interactive website at [www.mortgagebusiness.net](http://www.mortgagebusiness.net)



We the Agent have not tested any apparatus, fittings or services for this property. The plot size is intended merely as a guide and has not been officially measured or verified by the Agent. Photographs are for illustration only and may depict items which are not for sale or included in the sale of the property. As part of the service we offer we may recommend ancillary services to you which we believe may help you with your property transaction. We wish to make you aware, that should you decide to use these services we will receive a referral fee. For full and detailed information please visit 'terms and conditions' on our website [www.keithashton.co.uk](http://www.keithashton.co.uk)

Brentwood  
Tel. 01277 260858

Village Office  
Tel. 01277 375757

Lettings Office  
Tel. 01277 202200

Explore more @ [www.keithashton.co.uk](http://www.keithashton.co.uk)

