



Keith
Ashton

Heather Close, Pilgrims Hatch
Brentwood



11 HEATHER CLOSE

Pilgrims Hatch Brentwood, CM15 9QX

Guide Price £375,000 - £400,000

****Guide Price £375,000 - £400,000**** We are delighted to present this well-maintained three-bedroom mid-terrace home, situated in the popular Flowers Development in Pilgrims Hatch. Enjoying a peaceful outlook over a charming green, this property offers a welcoming setting for family living.

Tastefully presented throughout, the home is ideally located within close proximity to a selection of highly regarded primary and secondary schools, making it a perfect choice for families. Brentwood High Street and Train Station—offering direct access to London and beyond via the Elizabeth Line—are also easily reached, providing excellent transport links

- THREE BEDROOM FAMILY HOME
- NEWLY FITTED KITCHEN & BATHROOM
- FITTED WARDROBES
- GARAGE
- HIGHLY REGARDED SCHOOLS CLOSE BY
- POPULAR FLOWERS ESTATE
- EASY REACH OF THE HIGH STREET
- SHORT DRIVE TO BRENTWOOD STATION



Description

The internal layout begins with a generous porch, leading into a bright and welcoming lounge that flows effortlessly into the open-plan kitchen and dining area—ideal for both everyday family living and entertaining. The newly fitted kitchen features sleek eye and base-level units, ample worktop space, and integrated appliances, while the dining area enjoys French doors that open directly onto the rear garden, inviting natural light and creating a seamless indoor-outdoor connection.

Upstairs, the landing provides access to three well-proportioned bedrooms, each benefiting from fitted wardrobes, offering excellent storage solutions. A stylish, newly installed contemporary shower room completes the first floor.

Outside, the rear garden begins with a paved patio area, perfect for alfresco dining, leading onto a neat lawn bordered by mature shrubs. A paved pathway extends to a secondary seating area at the end of the garden and offers side access to the garage, which features an up-and-over door to the rear—providing secure off-street parking. To the front, an attractive garden enhances the property's kerb appeal.



GROUND FLOOR
508 sq.ft. (47.2 sq.m.) approx.

1ST FLOOR
355 sq.ft. (33.0 sq.m.) approx.

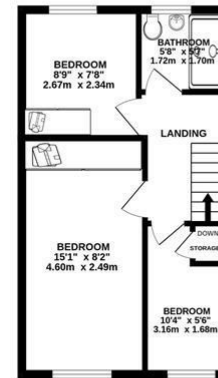
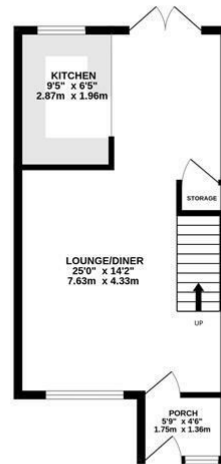
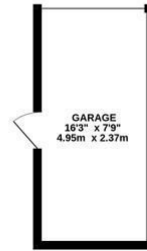

TOTAL FLOOR AREA : 863 sq.ft. (80.2 sq.m.) approx.
Measurements are approximate. Not to scale. Illustrative purposes only
Made with Metropix ©2025

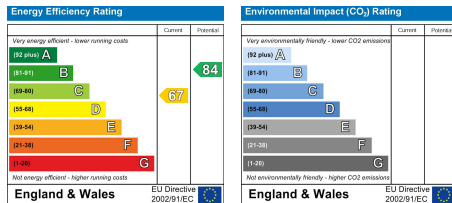

SERVICES:

Local Authority: Brentwood
Council tax band: D
Post code: CM15 9QX

VIEWING:

Strictly by prior arrangement with Keith Ashton Estate Agents

OPENING HOURS:

Monday to Friday: 8.45AM - 6.30PM | Saturdays: 9AM - 5.30PM | Sundays: 10AM - 2PM

MORTGAGE INFORMATION: We offer the additional facility of an in-house Independent Financial Adviser who will access all mortgage lenders with the purpose of providing you with the benefit of choice. For quotations or comparables please call 01277 260858 or visit our interactive website at www.mortgagebusiness.net



We the Agent have not tested any apparatus, fittings or services for this property. The plot size is intended merely as a guide and has not been officially measured or verified by the Agent. Photographs are for illustration only and may depict items which are not for sale or included in the sale of the property. As part of the service we offer we may recommend ancillary services to you which we believe may help you with your property transaction. We wish to make you aware, that should you decide to use these services we will receive a referral fee. For full and detailed information please visit 'terms and conditions' on our website www.keithashton.co.uk

Brentwood
Tel. 01277 260858

Village Office
Tel. 01277 375757

Lettings Office
Tel. 01277 202200

Explore more @ www.keithashton.co.uk

