

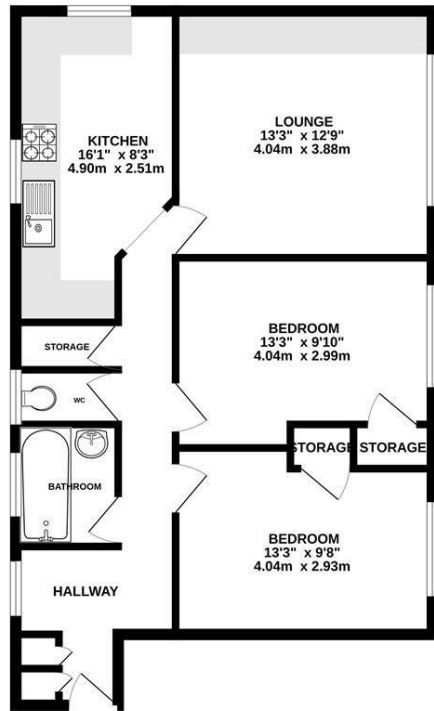

GROUND FLOOR
711 sq.ft. (66.1 sq.m.) approx.



TOTAL FLOOR AREA: 711 sq.ft. (66.1 sq.m.) approx.
Measurements are approximate. Not to scale. Illustrative purposes only.
Made with Metropix C2024



2 Theydon Bold Woodland Avenue, Hutton, Brentwood, CM13 1DH

We are pleased to bring to the market this spacious two double bedroom ground floor flat located within close proximity of Shenfield Station and its bustling High Street. The property is accessed via security entry phone and commences an entrance hall giving access to the sizeable lounge/diner, a modern fitted kitchen, comprising eye and base level storage units, ample worktop surfaces and plenty of space for appliances. There are two double bedrooms, a bathroom and separate WC. Externally there are gardens and parking of which are both communal.

Guide Price £250,000

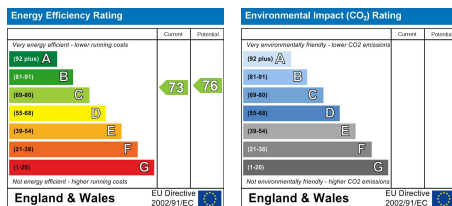

SERVICES:

Local Authority: Brentwood
Council tax band: B
Post code: CM13 1DH

VIEWING:

Strictly by prior arrangement with Keith Ashton Estate Agents

OPENING HOURS:

Monday to Friday: 8.45AM - 6.30PM | Saturdays: 9AM - 5.30PM | Sundays: 10AM - 2PM

MORTGAGE INFORMATION:

We offer the additional facility of an in-house Independent Financial Adviser who will access all mortgage lenders with the purpose of providing you with the benefit of choice. For quotations or comparables please call 01277 260858 or visit our interactive website at www.mortgagebusiness.net



We the Agent have not tested any apparatus, fittings or services for this property. The plot size is intended merely as a guide and has not been officially measured or verified by the Agent. Photographs are for illustration only and may depict items which are not for sale or included in the sale of the property. As part of the service we offer we may recommend ancillary services to you which we believe may help you with your property transaction. We wish to make you aware, that should you decide to use these services we will receive a referral fee. For full and detailed information please visit 'terms and conditions' on our website www.keithashton.co.uk

Brentwood
Tel. 01277 260858

Village Office
Tel. 01277 375757

Lettings Office
Tel. 01277 202200

Explore more @ www.keithashton.co.uk

