

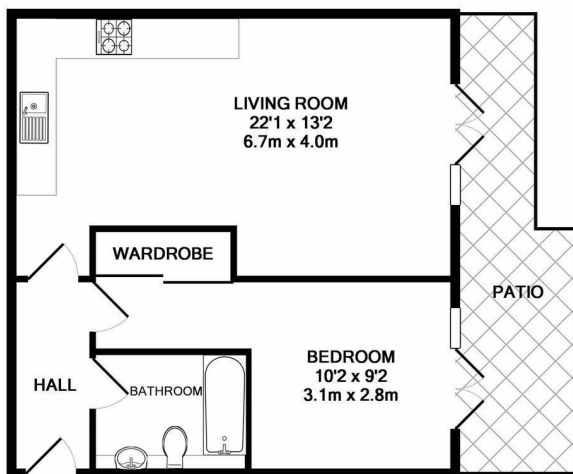

Keith  
Ashton

The Galleries, Warley  
Brentwood



TOTAL APPROX. FLOOR AREA 503 SQ.FT. (46.8 SQ.M.)

Whilst every attempt has been made to ensure the accuracy of the floor plan contained here, measurements of doors, windows, rooms and any other items are approximate and no responsibility is taken for any error, omission, or mis-statement. This plan is for illustrative purposes only and should be used as such by any prospective purchaser. The services, systems and appliances shown have not been tested and no guarantee as to their operability or efficiency can be given  
Made with Metropix ©2019



## I Rose Court The Galleries, Warley, Brentwood, CM14 5GJ

A beautifully presented ground floor apartment in Rose Court, which forms part of the award-winning Galleries Development, situated within walking distance of Brentwood's Mainline Station,

The hallway draws you to a lovely open plan kitchen/living area, with French Doors overlooking and leading to your own private terrace, perfect for outdoor relaxation. The fitted kitchen has gloss fronted wall and base units and a range of fully integrated appliances. There is a good-sized double bedroom, again with French doors leading to the terrace, with built-in wardrobes. An immaculate bathroom with a modern white suite completes the layout.

The apartment is accessed via a secure entry system and benefits from full concierge service. Rose Court is surrounded by impeccably kept gardens, to which you have full access. Allocated parking is also provided.

This beautifully appointed property set in fabulous grounds, is conveniently situated for Brentwood's Mainline Station and the vibrant town centre, making a perfect purchase for commuters or investors alike.



£320,000

### SERVICES:

Local Authority: Brentwood  
Council tax band: D  
Post code: CM14 5GJ

### VIEWING:

Strictly by prior arrangement with Keith Ashton Estate Agents

### OPENING HOURS:

Monday to Friday: 8.45AM - 6.30PM | Saturdays: 9AM - 5.30PM | Sundays: 10AM - 2PM

### MORTGAGE INFORMATION:

We offer the additional facility of an in-house Independent Financial Adviser who will access all mortgage lenders with the purpose of providing you with the benefit of choice. For quotations or comparables please call 01277 260858 or visit our interactive website at [www.mortgagebusiness.net](http://www.mortgagebusiness.net)

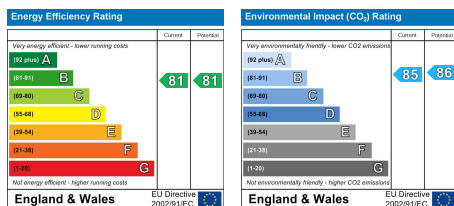

We the Agent have not tested any apparatus, fittings or services for this property. The plot size is intended merely as a guide and has not been officially measured or verified by the Agent. Photographs are for illustration only and may depict items which are not for sale or included in the sale of the property. As part of the service we offer we may recommend ancillary services to you which we believe may help you with your property transaction. We wish to make you aware, that should you decide to use these services we will receive a referral fee. For full and detailed information please visit 'terms and conditions' on our website [www.keithashton.co.uk](http://www.keithashton.co.uk)

Brentwood  
Tel. 01277 260858

Village Office  
Tel. 01277 375757

Lettings Office  
Tel. 01277 202200

Explore more @ [www.keithashton.co.uk](http://www.keithashton.co.uk)

