

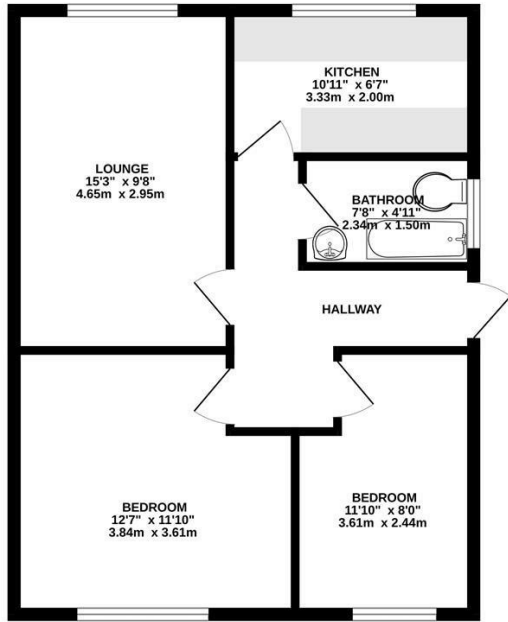

Keith
Ashton

Doddinghurst Road,
Brentwood

FIRST FLOOR
558 sq.ft. (51.9 sq.m.) approx.



TOTAL FLOOR AREA: 558 sq.ft. (51.9 sq.m.) approx.
Measurements are approximate. Not to scale. Illustrative purposes only.
Made with Metropix 12024.



90a Doddinghurst Road, Brentwood, CM15 9EU

A first floor purpose built two double bedroom maisonette with an impressive leasehold of over 900 years.

From your own front door leading to the spacious landing, you can access all the principal rooms, which include two double bedrooms, bathroom, bright living room and galley style kitchen fitted with eye and base level units.

Situated in a popular part of Brentwood with both Brentwood Town and the Brentwood Leisure centre falling within half a mile.

The property is in need of some updating in places and would be an excellent investment or first-time buyer opportunity. **NO ONWARD CHAIN**

Guide Price **£285,000**

SERVICES:

Local Authority: Brentwood
Council tax band: C
Post code: CM15 9EU

VIEWING:

Strictly by prior arrangement with Keith Ashton Estate Agents

OPENING HOURS:

Monday to Friday: 8.45AM - 6.30PM | Saturdays: 9AM - 5.30PM | Sundays: 10AM - 2PM

MORTGAGE INFORMATION: We offer the additional facility of an in-house Independent Financial Adviser who will access all mortgage lenders with the purpose of providing you with the benefit of choice. For quotations or comparables please call 01277 260858 or visit our interactive website at www.mortgagebusiness.net

Energy Efficiency Rating		Environmental Impact (CO ₂) Rating	
Current	Potential	Current	Potential
71	76	A	A
<p>Very energy efficient - lower running costs</p> <p>(82 plus) A</p> <p>(81-81) B</p> <p>(69-80) C</p> <p>(55-68) D</p> <p>(39-54) E</p> <p>(21-38) F</p> <p>(1-20) G</p> <p>Not energy efficient - higher running costs</p> <p>EU Directive 2002/91/EC</p> <p>England & Wales</p>		<p>Very environmentally friendly - lower CO₂ emissions</p> <p>(82 plus) A</p> <p>(81-81) B</p> <p>(69-80) C</p> <p>(55-68) D</p> <p>(39-54) E</p> <p>(21-38) F</p> <p>(1-20) G</p> <p>Not environmentally friendly - higher CO₂ emissions</p> <p>EU Directive 2002/91/EC</p> <p>England & Wales</p>	



We the Agent have not tested any apparatus, fittings or services for this property. The plot size is intended merely as a guide and has not been officially measured or verified by the Agent. Photographs are for illustration only and may depict items which are not for sale or included in the sale of the property. As part of the service we offer we may recommend ancillary services to you which we believe may help you with your property transaction. We wish to make you aware, that should you decide to use these services we will receive a referral fee. For full and detailed information please visit 'terms and conditions' on our website www.keithashton.co.uk

Brentwood
Tel. 01277 260858

Village Office
Tel. 01277 375757

Lettings Office
Tel. 01277 202200

Explore more @ www.keithashton.co.uk

