

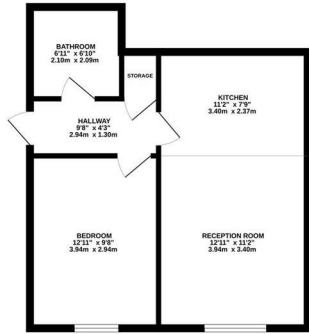

Keith
Ashton

William Hunter Way,
Brentwood

GROUND FLOOR
454 sq.ft. (42.2 sq.m.) approx.



TOTAL FLOOR AREA: 454 sq.ft. (42.2 sq.m.) approx.
Measurements are approximate. See floor plan for dimensions.



1 Luke Court William Hunter Way, Brentwood, CM14 4GQ

Set within just a stone's throw of Brentwoods vibrant high street, with its excellent options for shopping and socialising, we are delighted to offer for sale this one bedroom apartment. This exclusive development is only three years old and has been finished to a high standard inside and out, which is evident as you enter via the brick archway taking you through to the parking area. You are also within just half a mile of Brentwood mainline railway station, with its fast service into London Liverpool Street and the newly opened Elizabeth Line, with its convenient onward links,

Offers In Excess Of £240,000

Energy Efficiency Rating			Environmental Impact (CO ₂) Rating		
Very energy efficient - lower running costs	Current	Potential	Very environmentally friendly - lower CO ₂ emissions	Current	Potential
(81-91) A	81	81	(81-91) A	84	84
(69-80) B			(69-80) B		
(55-68) C			(55-68) C		
(39-54) D			(39-54) D		
(21-38) E			(21-38) E		
(9-20) F			(9-20) F		
(1-8) G			(1-8) G		
Not energy efficient - higher running costs			Not environmentally friendly - higher CO ₂ emissions		
England & Wales	EU Directive 2002/91/EC		England & Wales	EU Directive 2002/91/EC	

SERVICES:

Local Authority: Brentwood
Council tax band: D
Post code: CM14 4GQ

VIEWING:

Strictly by prior arrangement with Keith Ashton Estate Agents

OPENING HOURS:

Monday to Friday: 8.45AM - 6.30PM | Saturdays: 9AM - 5.30PM | Sundays: 10AM - 2PM

MORTGAGE INFORMATION:

We offer the additional facility of an in-house Independent Financial Adviser who will access all mortgage lenders with the purpose of providing you with the benefit of choice. For quotations or comparables please call 01277 260858 or visit our interactive website at www.mortgagebusiness.net



We the Agent have not tested any apparatus, fittings or services for this property. The plot size is intended merely as a guide and has not been officially measured or verified by the Agent. Photographs are for illustration only and may depict items which are not for sale or included in the sale of the property. As part of the service we offer we may recommend ancillary services to you which we believe may help you with your property transaction. We wish to make you aware, that should you decide to use these services we will receive a referral fee. For full and detailed information please visit 'terms and conditions' on our website www.keithashton.co.uk

Brentwood
Tel. 01277 260858

Village Office
Tel. 01277 375757

Lettings Office
Tel. 01277 202200

Explore more @ www.keithashton.co.uk

