

**FOR SALE**



**Broadwater Road, Welwyn Garden City**

**One Bedroom, Ground Floor Maisonette**

**GUIDE PRICE £250,000**





- **CHAIN FREE!**
- **Well Presented One Bedroom Maisonette/Apartment**
- **Open-Plan Kitchen/Lounge/Diner**
- **Secure Underground Parking Space**
- **EPC Rating Band C**
- **Walking Distance To Town Centre & mainline Train Station**
- **Perfect for First-Time Buyers or Investors!**

## SUMMARY

**CHAIN FREE!!** This beautiful one-bedroom ground floor maisonette is perfectly positioned for both the Town Centre amenities and excellent transport links to London Kings Cross within 30 minutes. The property comprises of an open-plan kitchen/diner/lounge area, one double bedroom, and a modern bathroom suite. The property further benefits from allocated parking and attractive communal grounds. Welwyn Garden City Town Centre offers a good selection of shops including John Lewis, Waitrose, Sainsbury, and other independent retailers, together with a variety of restaurants, bars, and the Campus West Entertainment Complex which features a Cinema, Library, Soft-Play, Roller City and many other amenities. Viewing is highly recommended as this property would be ideal for first-time buyers or investors!

## ENTRANCE HALL

Laminate floor, radiator with cover, cupboard housing hot water tank and storage space, smoke alarm, ceiling light.

Energy Efficiency Rating		
	Current	Potential
Very energy efficient - lower running costs		
(92+) <b>A</b>		
(81-91) <b>B</b>		
(69-80) <b>C</b>	79	79
(55-68) <b>D</b>		
(39-54) <b>E</b>		
(21-38) <b>F</b>		
(1-20) <b>G</b>		
Not energy efficient - higher running costs		
<b>England &amp; Wales</b>	EU Directive 2002/91/EC	



## OPEN-PLAN KITCHEN/LOUNGE/DINER BEDROOM 16' 5" x 9' 0" (5m x 2.75m) 19' 5" x 11' 4" (5.93m x 3.45m)

Laminate floor throughout, radiator, large double-glazed window to front aspect with fitted blind, ceiling lights. The kitchen area features a range of modern white wall and base units, stainless steel sink with mixer tap, wooden breakfast bar, integrated appliances including fridge-freezer, Zanussi oven and hob with extractor filter-hood over, under-cupboard lighting, washing machine, slimline dishwasher, extractor fan, ceiling light.

Laminate floor, radiator, built-in mirrored wardrobe/storage, double-glazed window to front aspect with fitted blind, ceiling light.

### EXTERNAL SPACE

Communal gardens, underground car park with allocated parking.

### BATHROOM

Tiled floor, white bathroom suite comprising low-level flush WC, pedestal sink with stainless steel taps, large vanity mirror, panel enclosed bath with stainless steel taps, rainfall shower, separate shower attachment, heated towel rail, fully tiled walls, extractor fan



Approximate Gross Internal Area = 46.5 sq m / 500 sq ft

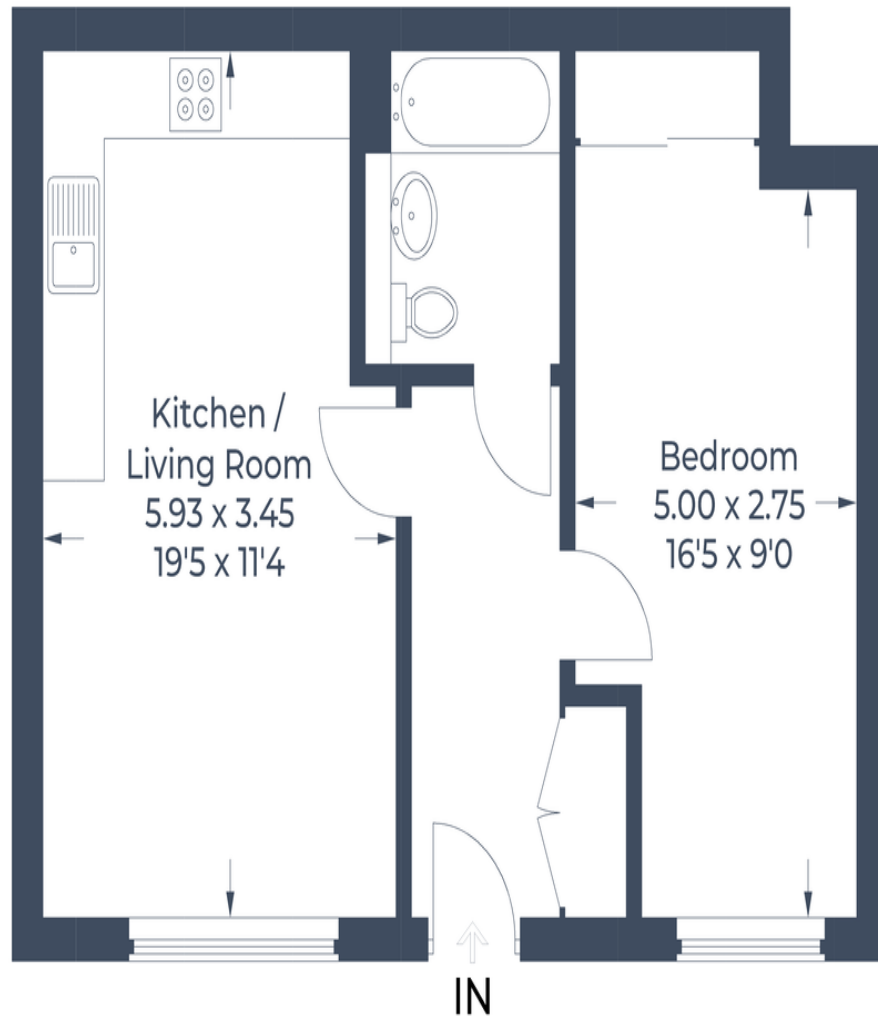

Illustration for identification purposes only,  
measurements are approximate, not to scale.  
© CJ Property Marketing Produced for Martin & Co

## Martin & Co Welwyn

16 Howardsgate • Welwyn Garden City • AL8 6BQ

T: 01707 334576 • E: welwyn@martinco.com

# 01707 334576

<http://welwyn.martinco.com>



**Accuracy:** References to the Tenure of a Property are based on information supplied by the Seller. The Agent has not had sight of the title documents. A Buyer is advised to obtain verification from their Solicitor. Items shown in photographs including but not limited to carpets, fixtures and fittings are not included unless specifically mentioned within the sales particulars. They may however be available by separate negotiation. Buyers must check the availability of any property and make an appointment to view before embarking on any journey to see a property. No person in the employment of the agent has any authority to make any representation about the property, and accordingly any information given is entirely without responsibility on the part of the agents, sellers(s) or lessors(s). Any property particulars are not an offer or contract, nor form part of one. **Sonic / Laser Tape:** Measurements taken using a sonic / laser tape measure may be subject to a small margin of error. **All Measurements:** All Measurements are Approximate. **Services Not tested:** The Agent has not tested any apparatus, equipment, fixtures and fittings or services and so cannot verify that they are in working order or fit for the purpose. A Buyer is advised to obtain verification from their Solicitor or Surveyor.