



Wessex Way, BICESTER, OX26 6AX

Guide Price £97,500 Leasehold

THOMAS
MERRIFIELD
SALES LETTINGS

The Property





Key Features

- Retirement Apartment
- Flagship McCarthy and Stone Development
- Assisted Living
- Lift to All Floors
- Excellent communal facilities and 24 hour site staffing
- Wet room with walk in shower
- Excellent central location
- 125 year Lease from 1/2/2001
- Council Tax: B
- Service Charge: £7,957.51 pa Review date: 31/8/24; Ground Rent: £330 pa Review date 31/06/24

The Location

Thomas Merrifield and their clients give notice that:

1. They are not authorised to make or give any representations or warranties in relation to the property either here or elsewhere, either on their own behalf or on behalf of their client or otherwise. They assume no responsibility for any statement that may be made in these particulars. These particulars do not form any part of any offer or contract and must not be relied upon as statements or representations of fact.

2. Any areas, measurements or distances are approximate. The text, photographs and plans are for guidance only and are not necessarily comprehensive. It should not be assumed that the property has all necessary planning, building regulation or other consents and Thomas Merrifield have not tested any services, equipment or facilities. Purchasers must satisfy themselves by inspection or otherwise.

APPROX. GROSS INTERNAL FLOOR AREA 549 SQ FT / 51 SQ M

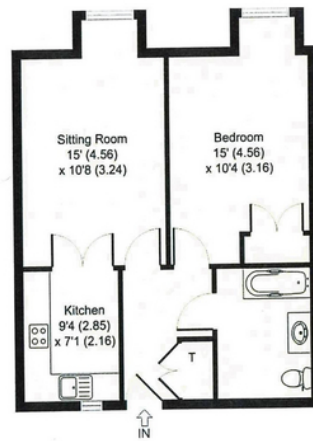

Bicester Office

39 Market Square, Bicester
Oxfordshire, OX26 6AG

T 01869 253 253

E bicester@thomasmerrifield.co.uk

W thomasmerrifield.co.uk

THOMAS
MERRIFIELD
SALES LETTINGS