



Quadrant Estate Agents

£1,250,000



Manor Barn Lodge,

Wendlebury, OX25 2PP

A fantastic opportunity to purchase a substantial period home with large reception rooms, a stylish kitchen/breakfast room, a two-bedroom cottage, and generous parking, which is perfect for contemporary family living in the pretty Oxfordshire village of Wendlebury.

www.quadrant-estates.co.uk

ACCOMMODATION

- Stone-Built Period Property
- Flexible Accommodation
- Stunning Sitting Room
- 1 Bed Annex, and A Cottage
- Double Carport, and Generous Driveway Parking
- Mature Enclosed Garden.
- Village Location
- Large Kitchen/Breakfast Room
- Vaulted Ceilings, Character Features
- Easy Access To Amenities and Commuter Links

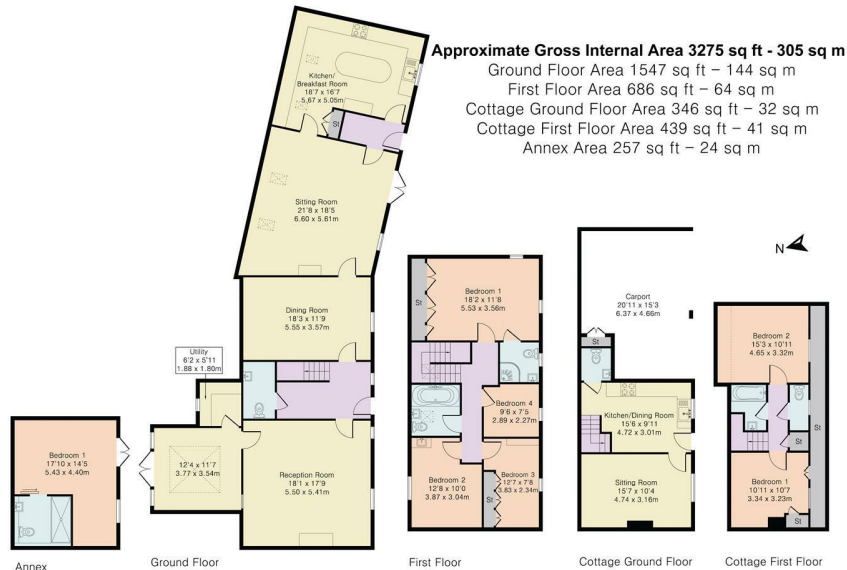

10Market Square, Bicester, Oxfordshire, OX26 6AD

t 01869 241166

sales@quadrant-estates.co.uk

IMPORTANT: we would like to inform prospective purchasers that these sales particulars have been prepared as a general guide only. A detailed survey has not been carried out, nor the services, appliances and fittings tested. Room sizes should not be relied upon for furnishing purposes and are approximate. If floor plans are included, they are for guidance only and illustration purposes only and may not be to scale. If there are any important matters likely to affect your decision to buy, please contact us before viewing the property.

www.quadrant-estates.co.uk