



Quadrant Estate Agents

£310,000



12, Dryden Avenue

Bicester, OX26 2NJ

A very well presented three bedroom semi detached family home located in Greenwood homes overlooking a green, close to local school and amenities. The property briefly comprises; entrance porch, living room with dining area, modern kitchen with a range of integrated appliances.

On the first floor there are three bedrooms and family bathroom.

To the outside there is a front garden being mainly laid to lawn overlooking a small green with gated side access leading to a private enclosed back garden with single garage, block paved driveway with additional car parking space secured behind double gates. An early appointment to view comes very highly recommended.

www.quadrant-estates.co.uk

ACCOMMODATION

- Three Bedroom Semi Detached Family Home
- Entrance Porch
- Living Room with Dining Area
- Gas to Radiator Heating
- Kitchen with Integrated Appliances
- Family Bathroom
- Front and Rear Gardens
- Overlooking a Green
- Garage and Parking behind Secure Gates
- Close to School & Local Amenities

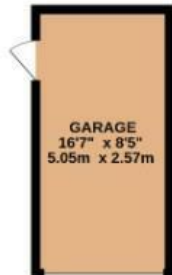
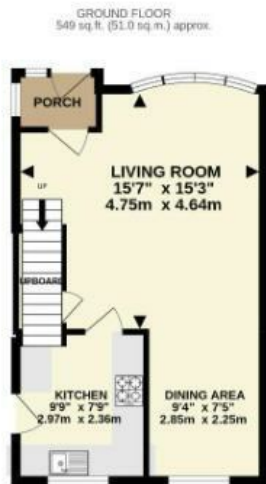

12 DRYDEN AVENUE, GREENWOOD HOMES, BICESTER, OXON. OX26 2NJ

TOTAL FLOOR AREA: 892 sq. ft. (82.9 sq. m.) approx.

Whilst every attempt has been made to ensure the accuracy of the floorplan contained here, measurements of doors, windows, rooms and any other items are approximate and no responsibility is taken for any error, omission or mis-statement. This plan is for illustrative purposes only and should be used as such by any prospective purchaser. The services, systems and appliances shown have not been tested and no guarantee as to their operability or efficiency can be given.

Made with Metropix ©2023



10Market Square, Bicester, Oxfordshire, OX26 6AD
t 01869 241166
sales@quadrant-estates.co.uk

IMPORTANT: we would like to inform prospective purchasers that these sales particulars have been prepared as a general guide only. A detailed survey has not been carried out, nor the services, appliances and fittings tested. Room sizes should not be relied upon for furnishing purposes and are approximate. If floor plans are included, they are for guidance only and illustration purposes only and may not be to scale. If there are any important matters likely to affect your decision to buy, please contact us before viewing the property.

www.quadrant-estates.co.uk