

Franklyn James



Island Row

London, E14 7HU

Asking Price £495,000

CHAIN FREE ! Introducing a fantastic opportunity to own a spacious two double bedroom apartment with a Juliette balcony overlooking the picturesque Limehouse Cut. This immaculately maintained property boasts a generous reception room with double doors to Juliette balcony.

The apartment features a separate fully fitted kitchen, a master bedroom with an en-suite shower room, a second double bedroom, and a stylish family bathroom.

In addition to its impressive newly decorated interior, this apartment offers the added convenience of gated underground parking and the peace of mind provided by an on-site porter. Situated on Island Row, this prime location is just a stone's throw away from Limehouse DLR station, granting effortless access to the vibrant Canary Wharf and the bustling City.

Don't miss out on the opportunity to make this exceptional property your own – schedule a viewing today.

- Perfect for first time buyers
- Gated secure parking
- Prime location
- Recently updated by the current vendors
- Minutes' walk to Limehouse DLR
- Chain free

Viewing

Please contact our Limehouse Sales Office on 02077911777 if you wish to arrange a viewing appointment for this property or require further information.



Franklyn James

Floor Plan

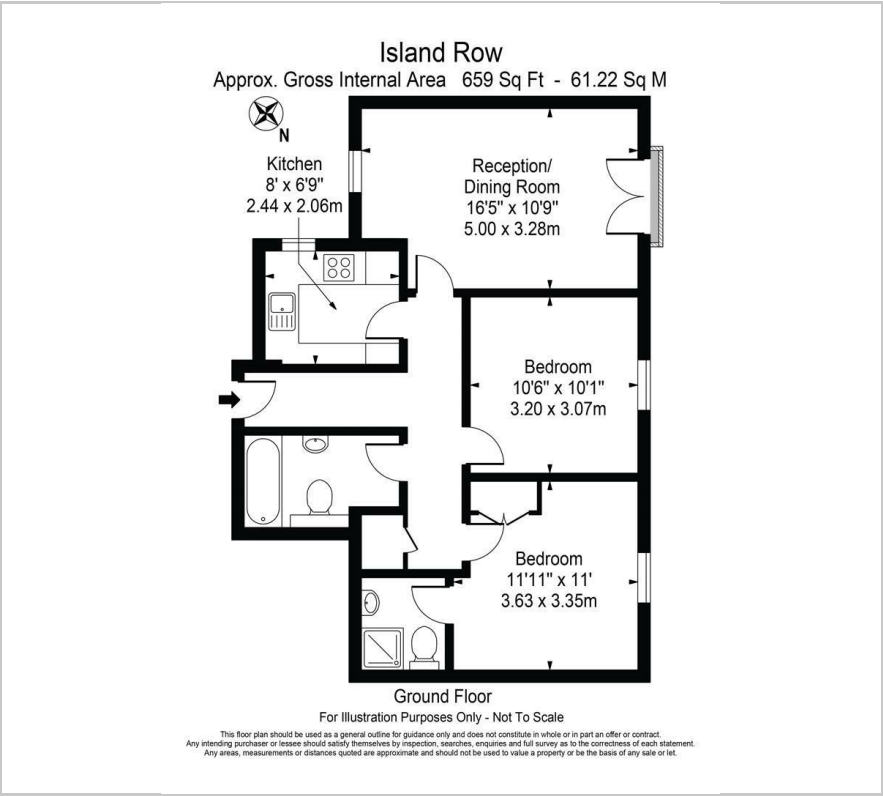

Area Map

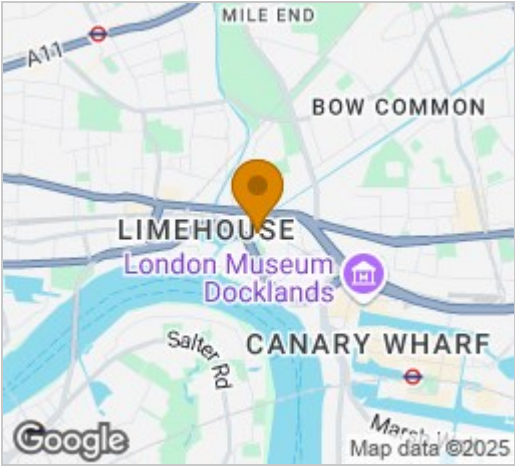

Energy Efficiency Graph

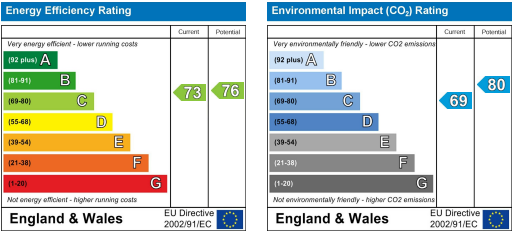

These particulars, whilst believed to be accurate are set out as a general outline only for guidance and do not constitute any part of an offer or contract. Intending purchasers should not rely on them as statements of representation of fact, but must satisfy themselves by inspection or otherwise as to their accuracy. No person in this firms employment has the authority to make or give any representation or warranty in respect of the property.