

Franklyn James



50 Narrow Street

, London, E14 8BZ

Asking Price £550,000

Nestled in the heart of Limehouse on the ever-popular Narrow Street, Paper Mill Wharf is a beautifully converted warehouse that effortlessly combines original charm with modern style. Right on the edge of the River Thames, this boutique development offers a sense of calm, character and a touch of luxury.

The communal areas have been tastefully refreshed, creating a smart and welcoming feel throughout the building. A daytime concierge is also on hand to make day-to-day life that little bit smoother.

If you enjoy an active lifestyle, this location is ideal. There are scenic riverside paths for running and dedicated cycle routes straight into the City. Canary Wharf is just a short walk away, and Limehouse station is close by for quick links into town.

Inside the apartment, you'll find two generously sized bedrooms and two newly renovated bathrooms, including a stylish en suite. It's a bright and spacious home with a layout that really works for modern living.

Offered chain free, it's a ready-to-go property in a prime East London spot.

Viewing

Please contact our Limehouse Sales Office on 02077911777 if you wish to arrange a viewing appointment for this property or require further information.

- Two spacious bedrooms
- Separate kitchen
- Renovated, modern bathrooms
- Riverside location
- Chain free
- Secure underground parking space



2



2



1



D

Floor Plan

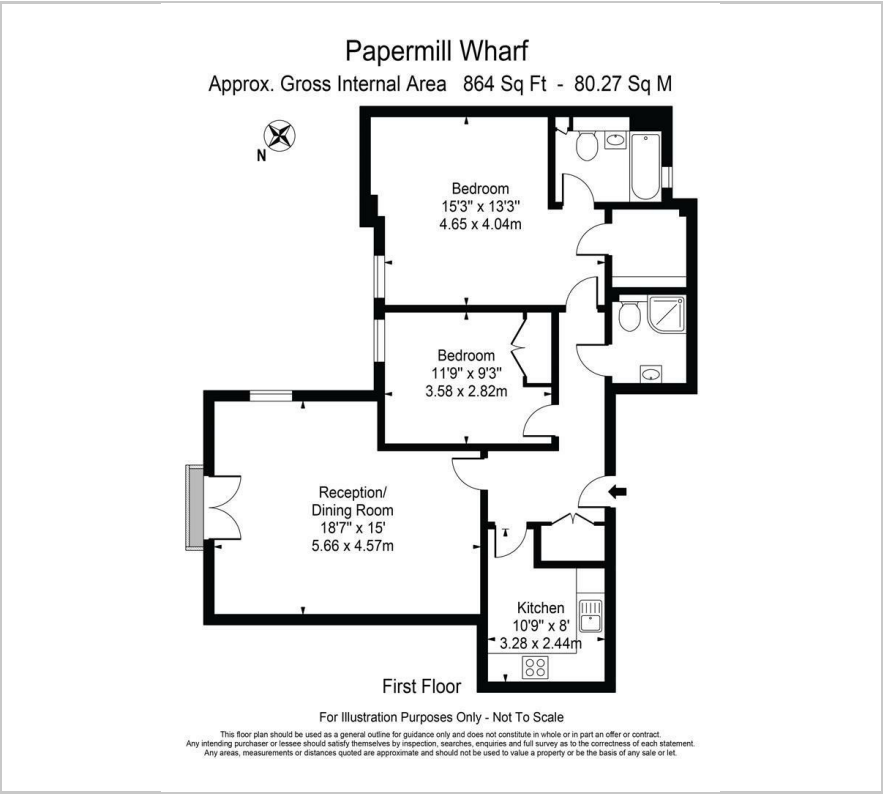

Area Map

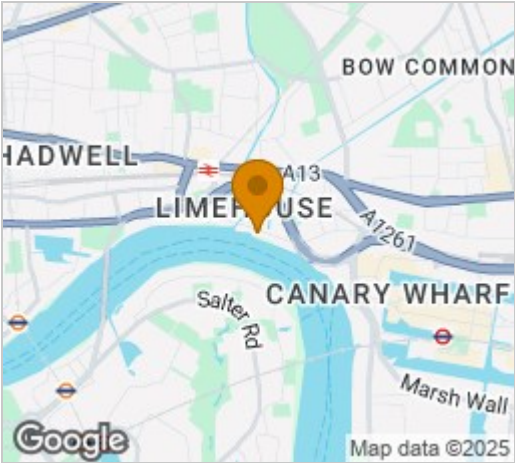

Energy Efficiency Graph

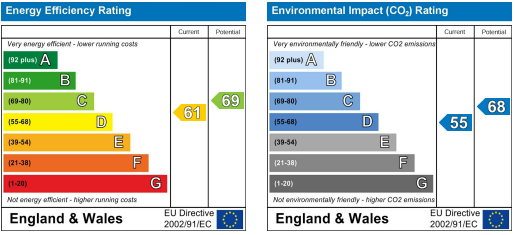

These particulars, whilst believed to be accurate are set out as a general outline only for guidance and do not constitute any part of an offer or contract. Intending purchasers should not rely on them as statements of representation of fact, but must satisfy themselves by inspection or otherwise as to their accuracy. No person in this firm's employment has the authority to make or give any representation or warranty in respect of the property.