

Franklyn James



Stoneyard Lane

, London, E14 0BY

Asking Price £375,000

Offered to the market with no onward chain, this two double bedroom apartment is located moments away from Canary Wharf. This attractive property comprises main entrance lobby, entrance hall, reception room, kitchen, master bedroom with access onto balcony, second double bedroom, and bathroom. Poplar and West India Quay DLR stations are within walking distance, making the City and other parts of London easily accessible. Be quick to arrange your viewing.

- Gated Development
- Allocated parking
- Ideal for a first time buy
- Two double bedrooms
- Convenient location
- Chain free
- Close to Canary Wharf

Viewing

Please contact our Limehouse Sales Office on 02077911777 if you wish to arrange a viewing appointment for this property or require further information.



Franklyn James

Floor Plan

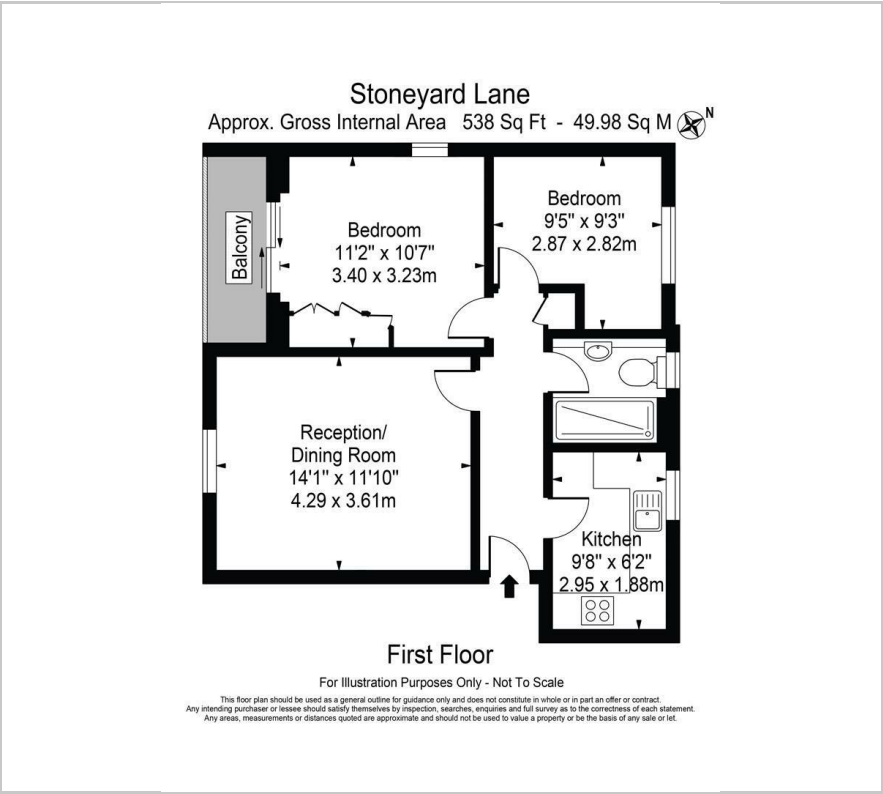

Area Map



Energy Efficiency Graph

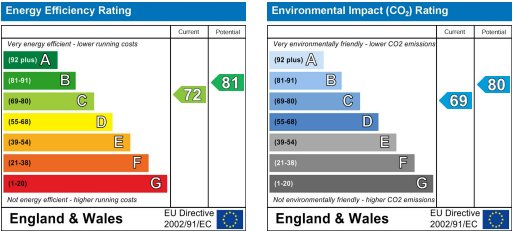

These particulars, whilst believed to be accurate are set out as a general outline only for guidance and do not constitute any part of an offer or contract. Intending purchasers should not rely on them as statements of representation of fact, but must satisfy themselves by inspection or otherwise as to their accuracy. No person in this firms employment has the authority to make or give any representation or warranty in respect of the property.