

Franklyn James



3 Basin Approach

, London, E16 2QW

Asking Price £450,000

Set within a modern waterside development, this stylish two-bedroom, two-bathroom apartment offers bright, contemporary living with impressive marina views. Floor-to-ceiling windows flood the space with natural light, while the open-plan living area flows seamlessly onto a private balcony – perfect for unwinding or entertaining. The main bedroom features a sleek en-suite, complemented by a second double bedroom and a spacious main bathroom. With lift access, private parking, and a superb location just moments from Gallions Reach DLR, it's ideal for city professionals or frequent flyers. Early viewing is highly recommended to truly appreciate the space and setting.

- Two-bedroom, two-bathroom apartment
- Stunning marina views
- Private balcony
- Secure development with lift access
- Allocated private parking
- Excellent transport links via Gallions Reach DLR

Viewing

Please contact our Limehouse Sales Office on 02077911777 if you wish to arrange a viewing appointment for this property or require further information.



Floor Plan

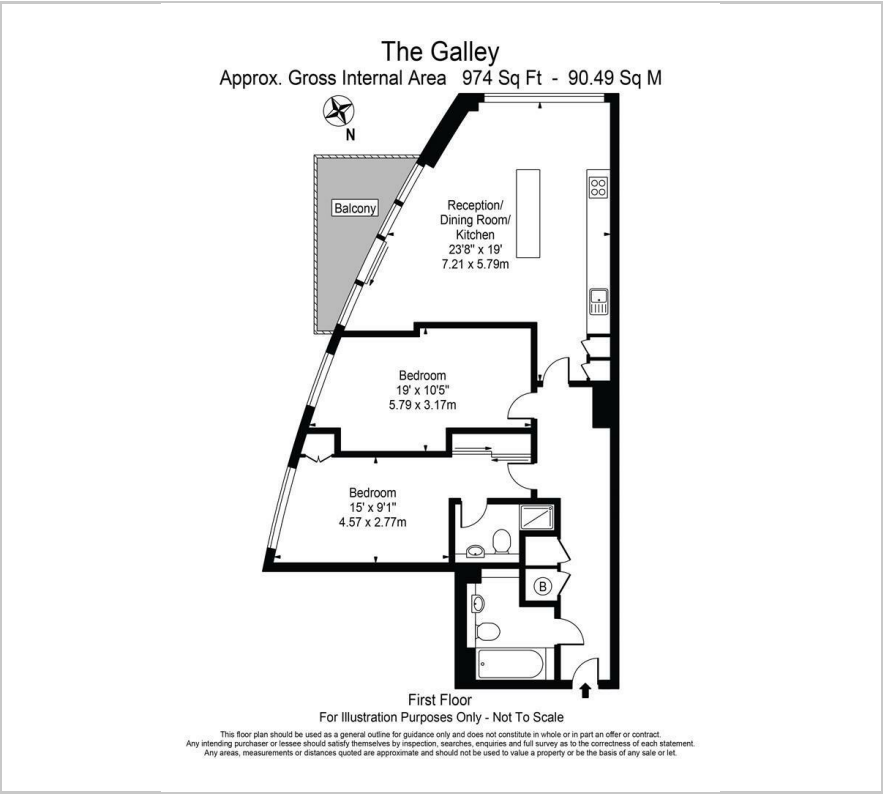

Area Map



Energy Efficiency Graph

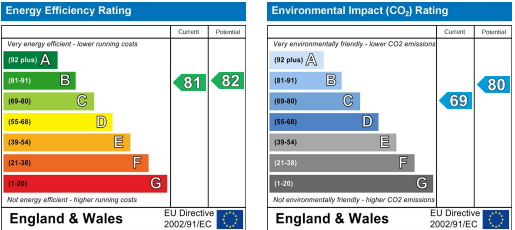

These particulars, whilst believed to be accurate are set out as a general outline only for guidance and do not constitute any part of an offer or contract. Intending purchasers should not rely on them as statements of representation of fact, but must satisfy themselves by inspection or otherwise as to their accuracy. No person in this firms employment has the authority to make or give any representation or warranty in respect of the property.