

Franklyn James



747 Commercial Road

, London, E14 7LE

Offers In Excess Of £325,000

Guide Price: £350,000 to £375,000
EWS1 Compliant

Set on an upper floor of the iconic Grade II-listed 1930s Seamen's Refuge this chain-free one-bedroom apartment seamlessly blends historic character with contemporary living. The apartment features a spacious open-plan living and dining area offering plenty of room for relaxation and entertaining. The generously sized double bedroom is bathed in natural light creating a serene retreat. Situated in a vibrant neighborhood, the property is surrounded by an array of cafes, restaurants and shops.

Residents enjoy a range of premium amenities including a fully equipped gym, a beautifully landscaped rooftop terrace, lift access and the convenience of an onsite porter.

Ideally located just moments from Canary Wharf and the City it boasts excellent transport links via Limehouse and Westferry DLR stations.

- Leasehold
- Chain free
- Stunning Grade II Listed 1930s converted old Seamen's Refuge
- One spacious double bedroom
- One bathroom
- Communal roof garden
- Residents Gym
- On site porter
- Moments away from Westferry and Limehouse DLR
- Easy access into Canary Wharf and the City

Viewing

Please contact our Limehouse Sales Office on 02077911777 if you wish to arrange a viewing appointment for this property or require further information.



Floor Plan

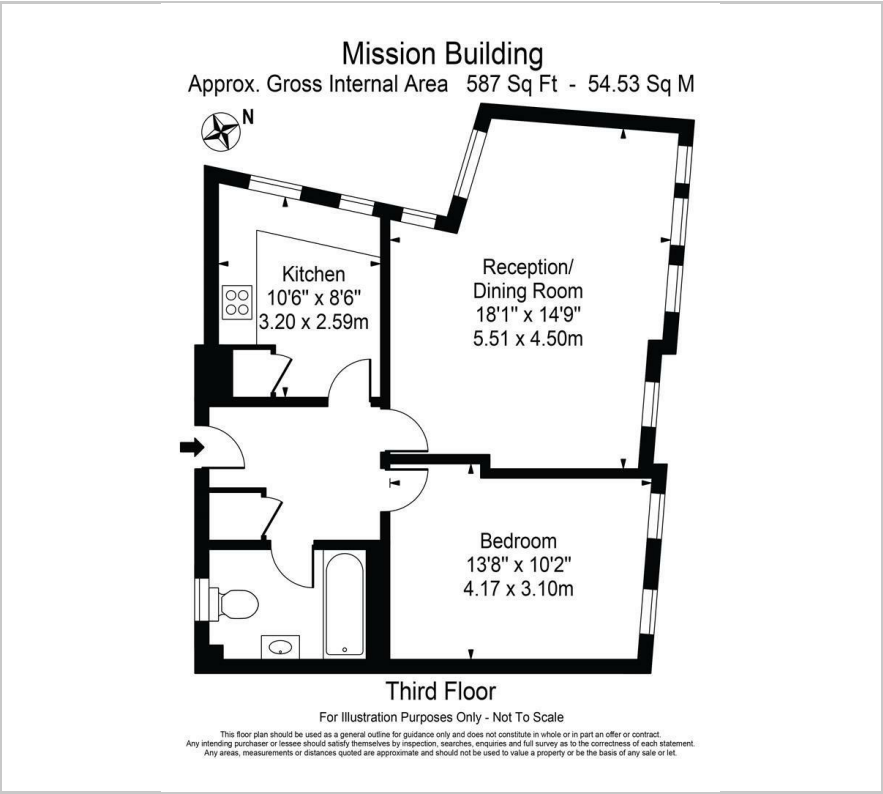

Area Map



Energy Efficiency Graph

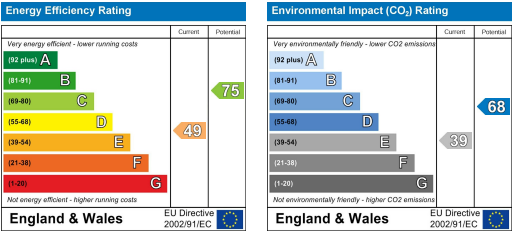

These particulars, whilst believed to be accurate are set out as a general outline only for guidance and do not constitute any part of an offer or contract. Intending purchasers should not rely on them as statements of representation of fact, but must satisfy themselves by inspection or otherwise as to their accuracy. No person in this firm's employment has the authority to make or give any representation or warranty in respect of the property.