

# Franklyn James



## 598 Commercial Road

, London, E14 7JR

Offers In Excess Of £539,000

A spacious 2-bedroom, 2-bathroom apartment with a parking space situated on the 5th floor within Zenith Building which offers an exceptional living experience with panoramic vistas of Limehouse Marina and the iconic Canary Wharf skyline.

As you step inside, you're greeted by an open-plan living space filled with natural light, thanks to floor-to-ceiling windows that frame the picturesque scenery. The contemporary kitchen features high-end appliances and ample storage, perfect for both cooking enthusiasts and casual diners. The generous living area seamlessly connects to a private balcony, ideal for relaxing or entertaining while soaking in the vibrant atmosphere of the waterfront.

Both bedrooms are generously sized, with the master suite boasting an en-suite bathroom for added privacy. The second bedroom is versatile, perfect for guests, a home office, or a cozy sanctuary. Each bathroom is elegantly designed with modern finishes and stylish fixtures.

Located just a stone's throw from Limehouse Station and the charming Narrow Street, you'll enjoy easy access to public transport, local shops, and delightful riverside restaurants. Embrace the vibrant community and enjoy the convenience of city living with the tranquility of marina views.

Don't miss the opportunity to make this exceptional apartment your own—schedule a viewing

- Fantastic view of Limehouse basin and Canary Wharf
- Ideal location for Limehouse DLR & C2C station
- Parking space
- Open plan lounge/kitchen
- 949 sqft of living space
- Sub Penthouse 5th Floor
- Balcony
- Lift
- 2 bed 2 bath

### Viewing

Please contact our Limehouse Sales Office on 02077911777 if you wish to arrange a viewing appointment for this property or require further information.



2



2



1



C

Franklyn



Floor Plan

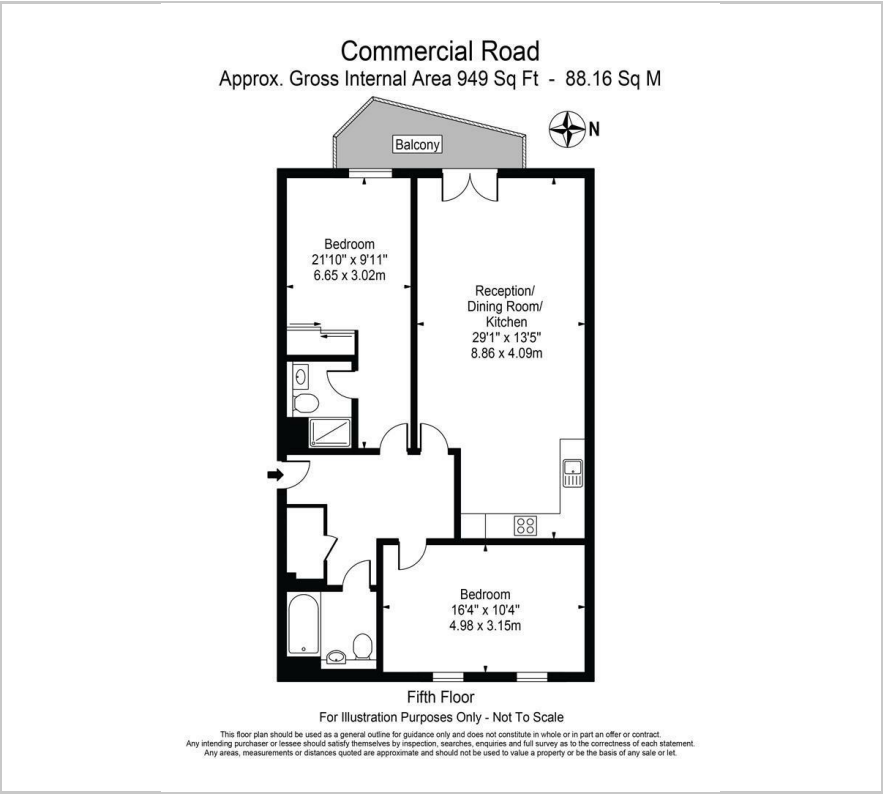

Area Map



Energy Efficiency Graph

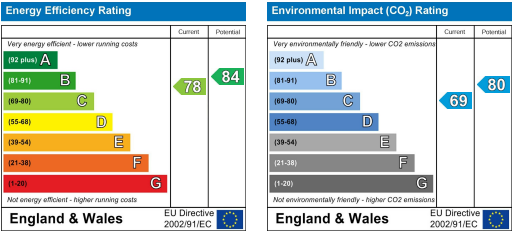

These particulars, whilst believed to be accurate are set out as a general outline only for guidance and do not constitute any part of an offer or contract. Intending purchasers should not rely on them as statements of representation of fact, but must satisfy themselves by inspection or otherwise as to their accuracy. No person in this firms employment has the authority to make or give any representation or warranty in respect of the property.