

Franklyn James



Rhodeswell Road, London, E14 7TT Offers In The Region Of £350,000

Offered chain free is this fantastic top-floor two-bedroom apartment, fully refurbished to a high standard throughout. This bright and spacious residence features a generous reception room, perfect for relaxation and entertaining. The separate fitted kitchen is equipped with brand-new appliances, making it a dream for any home cook. You'll find two well-proportioned double bedrooms, offering ample space and comfort, alongside a sleek modern bathroom.

Dora House is ideally situated on Rhodeswell Road, just a short stroll from Limehouse DLR station, providing excellent transport links to the city and beyond. This property combines contemporary living with convenience, making it an ideal choice for those seeking a stylish home in a prime location

- Chain free
- Top floor fully refurbished apartment
- Two double bedrooms
- Bright and spacious reception room
- Modern kitchen
- Well maintained throughout
- Excellent transport links
- Local amenities
- Close proximity to Limehouse DLR station.

Viewing

Please contact our Limehouse Lettings Office on 02077911777 if you wish to arrange a viewing appointment for this property or require further information.



Floor Plan

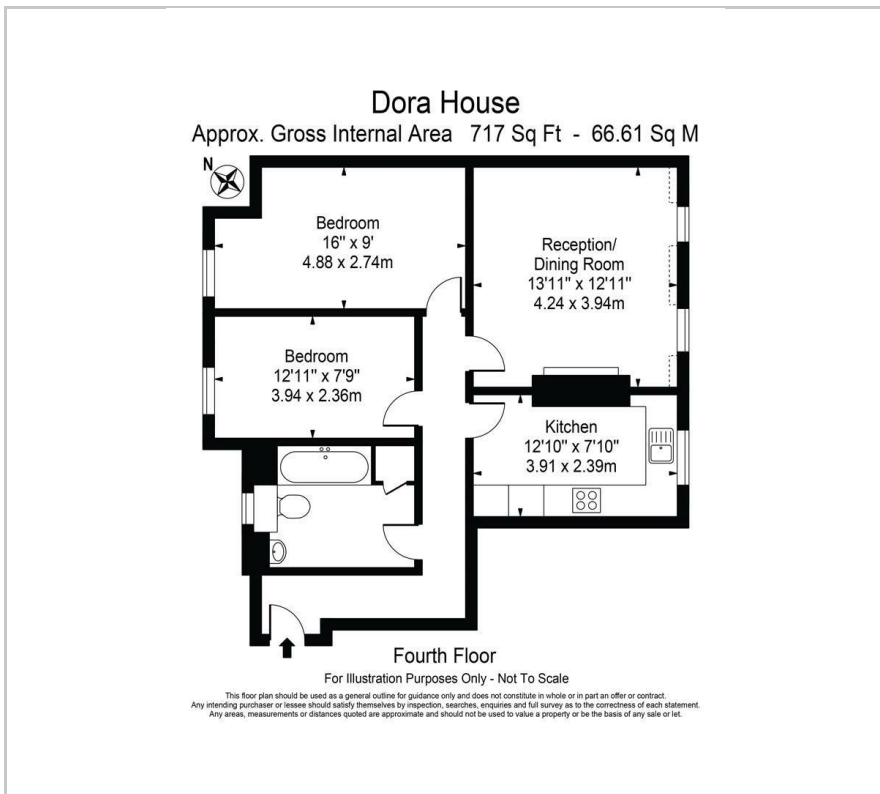

Area Map



Energy Efficiency Graph

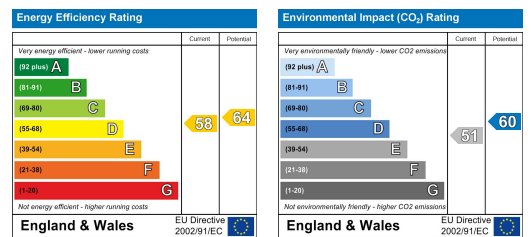

These particulars, whilst believed to be accurate are set out as a general outline only for guidance and do not constitute any part of an offer or contract. Intending purchasers should not rely on them as statements of representation of fact, but must satisfy themselves by inspection or otherwise as to their accuracy. No person in this firm's employment has the authority to make or give any representation or warranty in respect of the property.