

Franklyn James



8 Cotall Street

, London, E14 6TL

£475,000

Chain free - Discover this exceptional two-bedroom, two-bathroom apartment with full-height windows that open onto a generous private balcony, offering stunning views of Bartlett Park and Canary Wharf. This contemporary residence features a spacious open-plan living area with a modern well equipped kitchen with integrated appliances, two equal size bedrooms (one with en-suite) a storage cupboard which has been converted into a pantry.

Nestled in a tranquil residential area ideal for families and professionals. It's directly opposite Bartlett Park and just a short walk from Crisp Street Market, known for its vibrant stalls and street food events. Westfield Stratford City is within a 30-minute reach, and the apartment is conveniently located near Limehouse Cut Canal. The property is a very convenient 10 minute walk to Canary wharf underground station, providing access to the Jubilee line and Elizabeth line, travelling into the city. Transport links also include Langdon Park DLR (0.4 miles) and Westferry DLR (0.7 miles).

- Chain free
- Fantastic Views of Bartlett Park & Canary Wharf
- Open plan kitchen/Lounge
- Modern interiors
- Tranquil location
- Popular development
- Balcony
- Lift

Viewing

Please contact our Limehouse Sales Office on 02077911777 if you wish to arrange a viewing appointment for this property or require further information.



Floor Plan

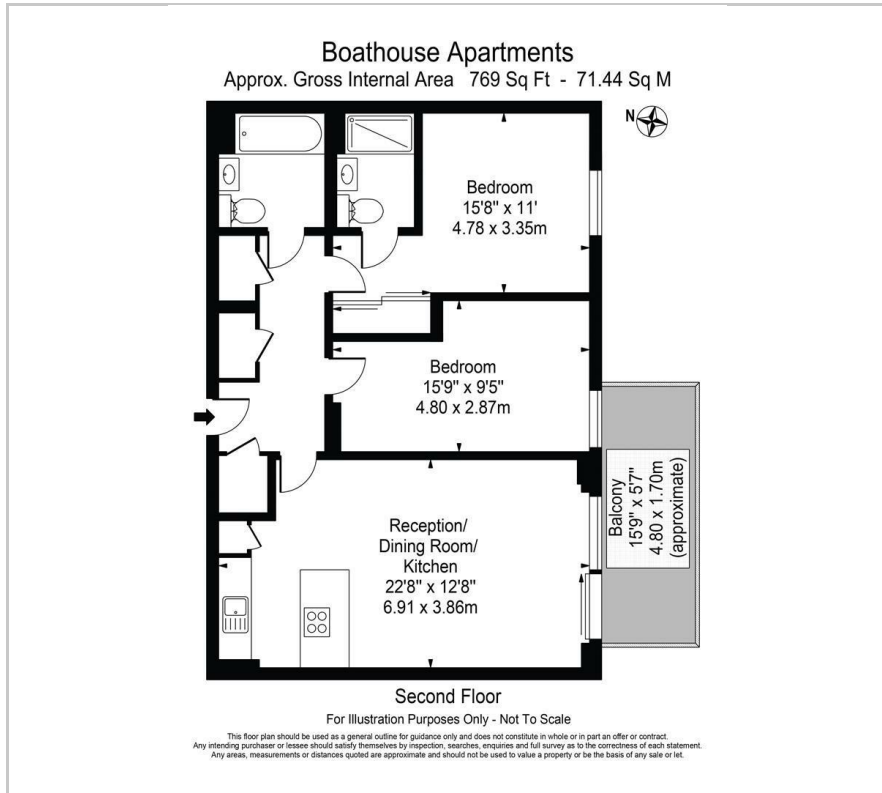

Area Map



Energy Efficiency Graph

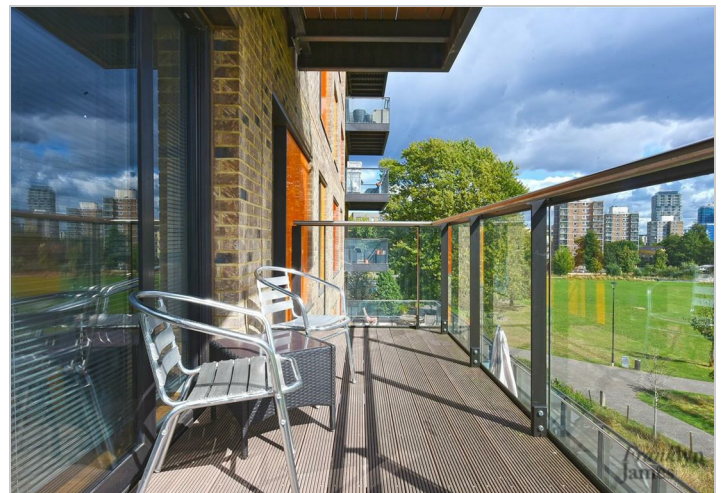
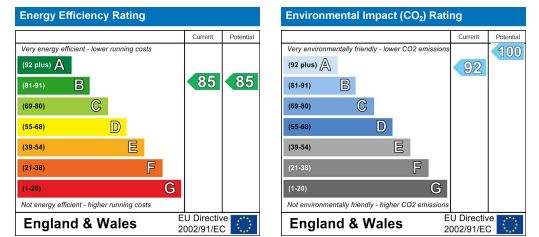

These particulars, whilst believed to be accurate are set out as a general outline only for guidance and do not constitute any part of an offer or contract. Intending purchasers should not rely on them as statements of representation of fact, but must satisfy themselves by inspection or otherwise as to their accuracy. No person in this firm's employment has the authority to make or give any representation or warranty in respect of the property.