

# Franklyn James



## 106 Narrow Street

, London, E14 8BU

£485,000

Offering over 530 sq ft of internal living space is this fantastic one bedroom apartment located in the popular Duke Shore Wharf development which is situated on Narrow Street. Occupying a second floor position, this apartment has been updated throughout and consists of entrance hall with storage cupboard, bright and spacious reception room leading to a private, full width balcony which faces the River, fully fitted kitchen with base and wall units, double bedroom with a built-in wardrobe and access to the balcony and modern family bathroom. This property also has allocated parking space in the courtyard behind gates. Duke Shore Wharf is ideally located on Narrow Street being within close proximity to Westferry DLR station, Limehouse DLR station, the Thames footpath and Canary Wharf.

- One bedroom
- Private balcony
- River views
- Spacious throughout
- Previously refurbished
- Ideally located
- Allocated Parking
- Narrow Street

### Viewing

Please contact our Limehouse Sales Office on 02077911777 if you wish to arrange a viewing appointment for this property or require further information.



1



1



1

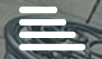

C

## Floor Plan

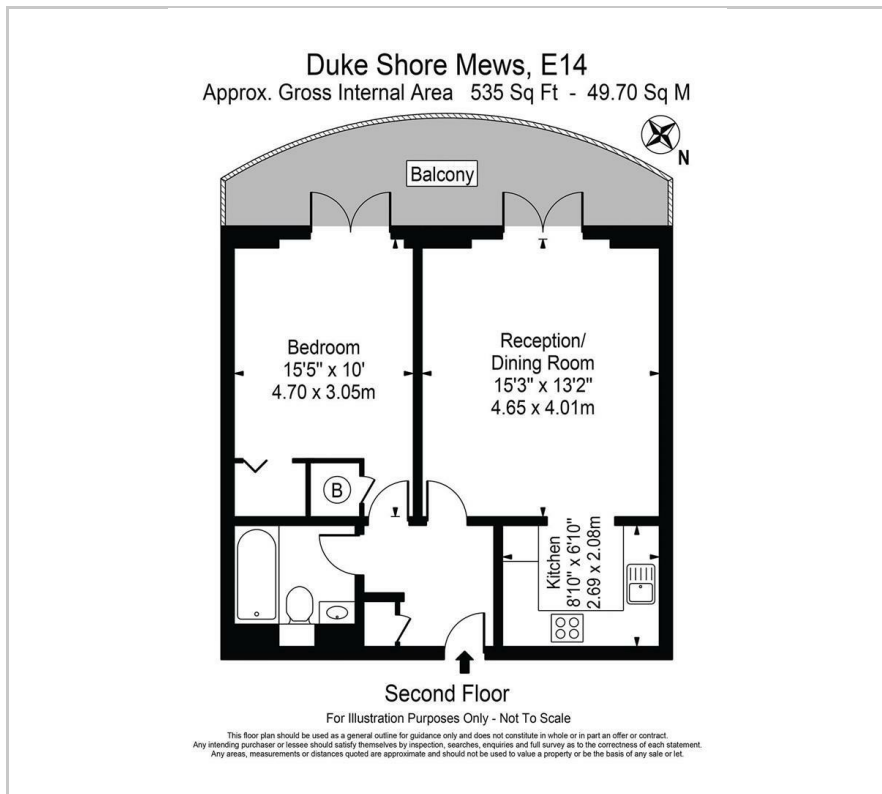

## Area Map

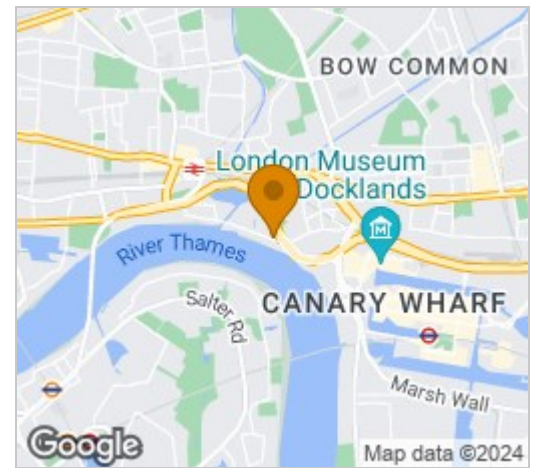

## Energy Efficiency Graph

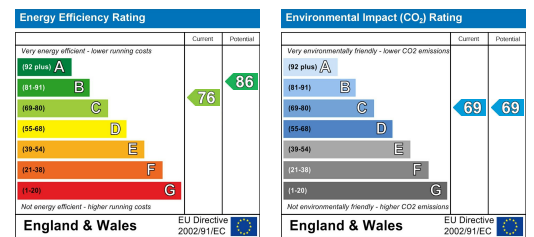

These particulars, whilst believed to be accurate are set out as a general outline only for guidance and do not constitute any part of an offer or contract. Intending purchasers should not rely on them as statements of representation of fact, but must satisfy themselves by inspection or otherwise as to their accuracy. No person in this firm's employment has the authority to make or give any representation or warranty in respect of the property.