

Franklyn James



51 Narrow street, London, E14 8DN

£410,000

CHAIN FREE. Located on Narrow Street, this stunning one-bedroom apartment is part of "The Mosaic" development. The area is known for its vibrant selection of bars and restaurants. The apartment features a spacious open-plan reception room with a fully integrated kitchen, a large double bedroom with a walk-in wardrobe, a three-piece bathroom suite, and a west-facing balcony that offers plenty of natural light. Residents also benefit from a 24-hour concierge service and a secure parking bay. Convenient transport links via Limehouse DLR and Mainline services provide easy access to Bank, Canary Wharf, and Fenchurch.

- Reserved underground gated parking spot
- 24 Hour concierge
- 2 min walk to Limehouse station with access to Bank, Canary Wharf and Fenchurch Street.
- West facing balcony
- Chain free
- Open plan living

Please contact our Limehouse Sales Office on 02077911777 if you wish to arrange a viewing appointment for this property or require further information.



1



1



1

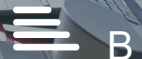

B

Floor Plan

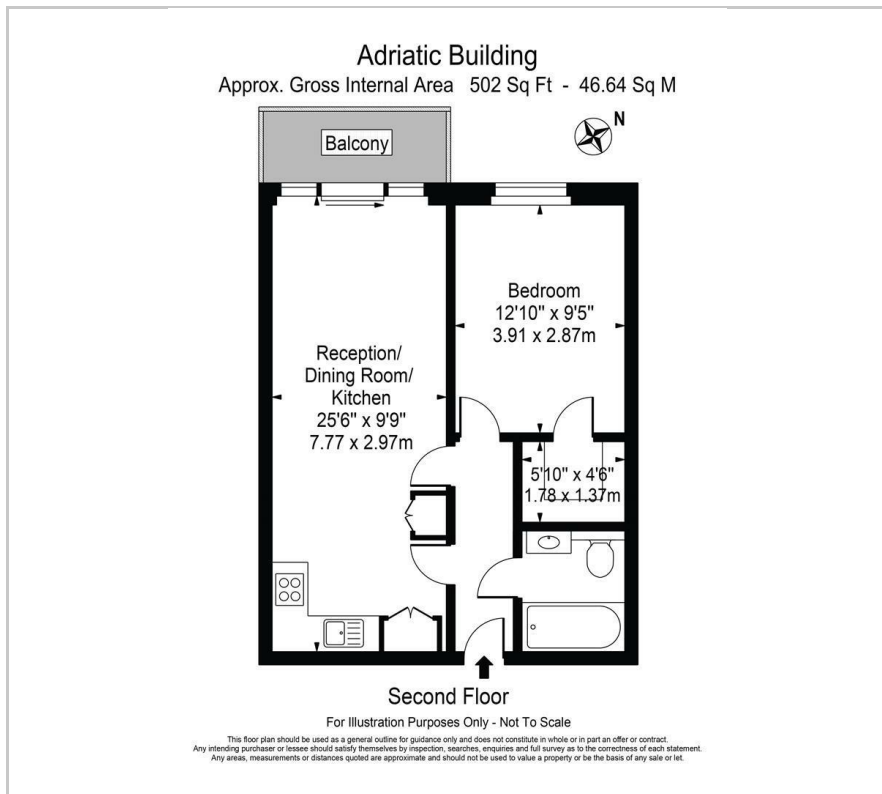

Area Map



Energy Efficiency Graph

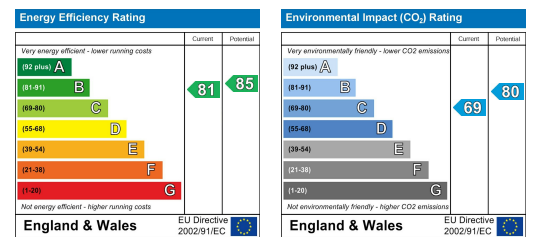

These particulars, whilst believed to be accurate are set out as a general outline only for guidance and do not constitute any part of an offer or contract. Intending purchasers should not rely on them as statements of representation of fact, but must satisfy themselves by inspection or otherwise as to their accuracy. No person in this firm's employment has the authority to make or give any representation or warranty in respect of the property.