

Franklyn James



Basin Approach

, London, E14 7JA

Guide Price £450,000

This exceptional two-bedroom, two-bathroom apartment offers over 828 square feet of living space in the heart of Limehouse Marina. The property features an entrance hall with ample storage, leading to two generously sized double bedrooms with built-in storage. The bright and spacious reception room, seamlessly integrated with an open-plan kitchen extends to a private balcony that provides breathtaking views of Limehouse Marina.

Additional amenities include a secure underground parking space, cycle parking facilities and the convenience of a 24-hour porter service.

Basin Approach is situated on Limehouse Marina, providing easy access to an array of local amenities, including a variety of restaurants and bars. The property is also just a few minutes' walk from Limehouse DLR station and the charming Narrow Street, known for its historic charm and vibrant atmosphere.

- Spacious two bedroom apartment
- Two bathroom
- Marina views
- Secure underground parking and cycle storage
- 24 hour porter
- Generous balcony space
- Recently refurbished - floors and painting
- Abundance of natural light
- Moments away from Limehouse DLR
- Easy access into Canary Wharf and City

Viewing

Please contact our Limehouse Sales Office on 02077911777 if you wish to arrange a viewing appointment for this property or require further information.

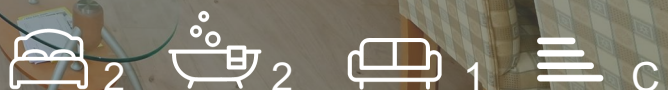

Franklyn James

Floor Plan

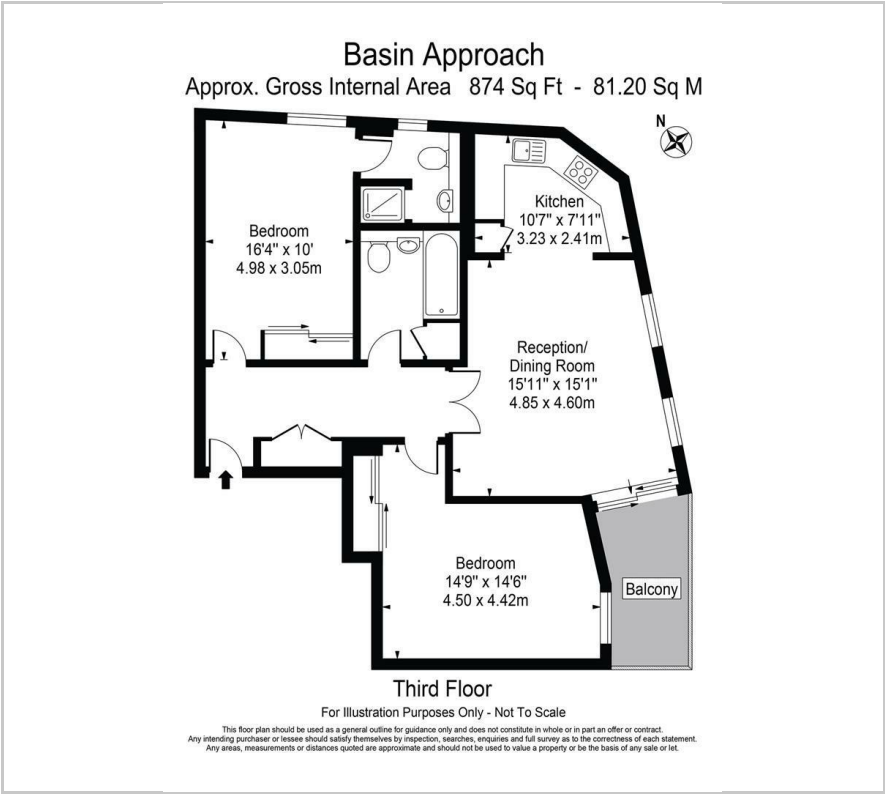

Area Map



Energy Efficiency Graph

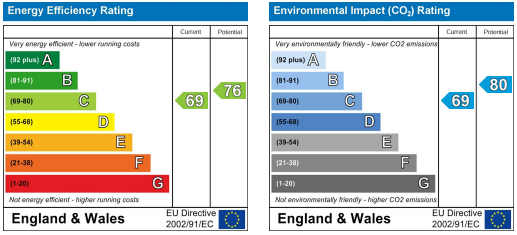

These particulars, whilst believed to be accurate are set out as a general outline only for guidance and do not constitute any part of an offer or contract. Intending purchasers should not rely on them as statements of representation of fact, but must satisfy themselves by inspection or otherwise as to their accuracy. No person in this firms employment has the authority to make or give any representation or warranty in respect of the property.