

# Franklyn James



## 7 Branch Road

, London, E14 7JX

Asking Price £550,000

Offered with no onward chain - A spacious 2-bedroom, 2-bathroom apartment in Berglen Court, Limehouse E14. This modern residence offers spacious living accommodation with an open-plan kitchen and lounge area, complemented by a balcony. Ideally situated near Narrow Street, it provides easy access to a variety of bars and restaurants. The apartment is perfectly positioned for swift access to Canary Wharf and 5 minutes access to Bank station, making it an ideal choice for those seeking a vibrant and convenient lifestyle.

- No onward chain
- 2 bed 2 bath
- Open plan kitchen/lounge
- A stones throw away from Limehouse Station
- Easy access to Canary Wharf
- Bright and spacious accomodation
- 999 Lease
- Underground parking
- 5 minutes from Bank station

### Viewing

Please contact our Limehouse Sales Office on 02077911777 if you wish to arrange a viewing appointment for this property or require further information.



# Floor Plan

# Area Map

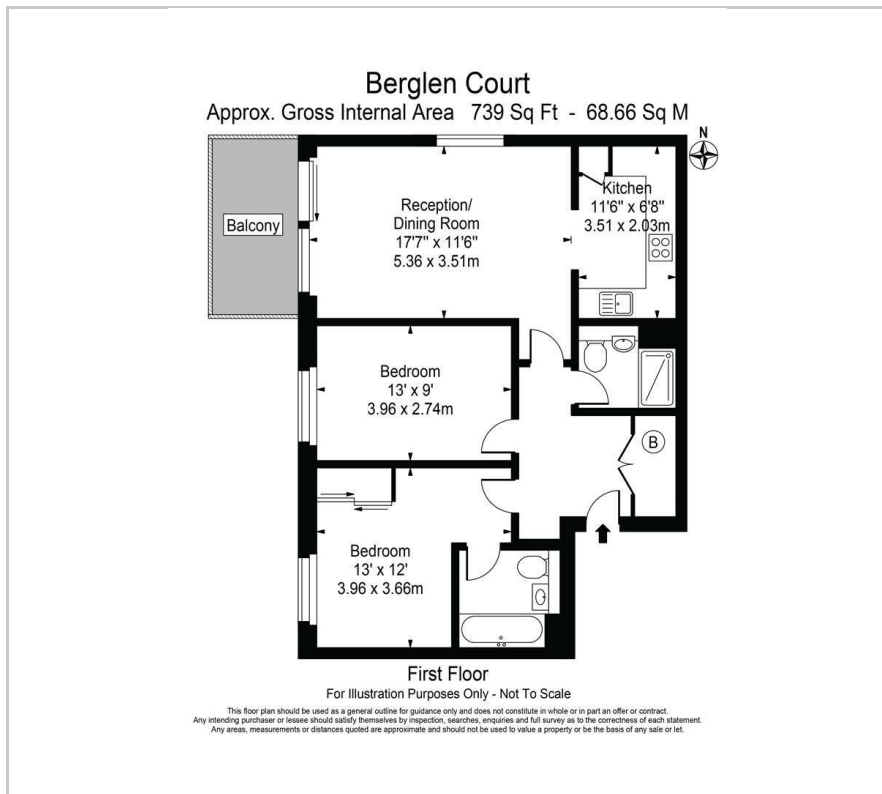

# Energy Efficiency Graph

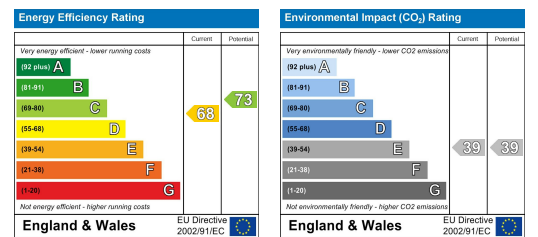

These particulars, whilst believed to be accurate are set out as a general outline only for guidance and do not constitute any part of an offer or contract. Intending purchasers should not rely on them as statements of representation of fact, but must satisfy themselves by inspection or otherwise as to their accuracy. No person in this firm's employment has the authority to make or give any representation or warranty in respect of the property.