

Franklyn James



Branch Road

, London, E14 7JZ

Guide Price £390,000

A bright and spacious 1-bedroom apartment overlooking the picturesque Limehouse Basin with allocated parking. With its contemporary design and ample natural light, this stylish property presents a perfect blend of comfort and sophistication. This apartment is offered in excellent decorative order and is ideal for first time buyers. Nestled nearby in the vibrant atmosphere of Narrow Street where you will find local amenities such as Gordon Ramsay's Bread Street restaurant and several other waterside pubs. Ideally located for Limehouse DLR & C2C providing swift access into Canary Wharf and The City makes this an enviable position. Call now to secure your viewing

- LIMEHOUSE BASIN VIEW
- IDEAL FOR FIRST TIME BUYERS
- ALLOCATED PARKING
- BRIGHT AND SPACIOUS LIVING
- EXCELLENT CONDITION
- ENVIABLY LOCATED
- GREAT SIZE APARTMENT

Viewing

Please contact our Limehouse Sales Office on 02077911777 if you wish to arrange a viewing appointment for this property or require further information.



1



1



1



Floor Plan

Area Map

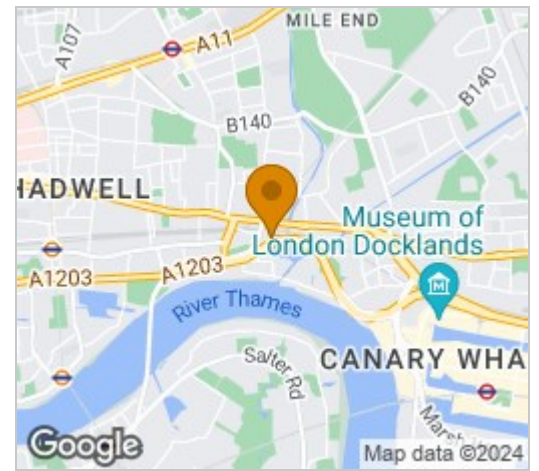
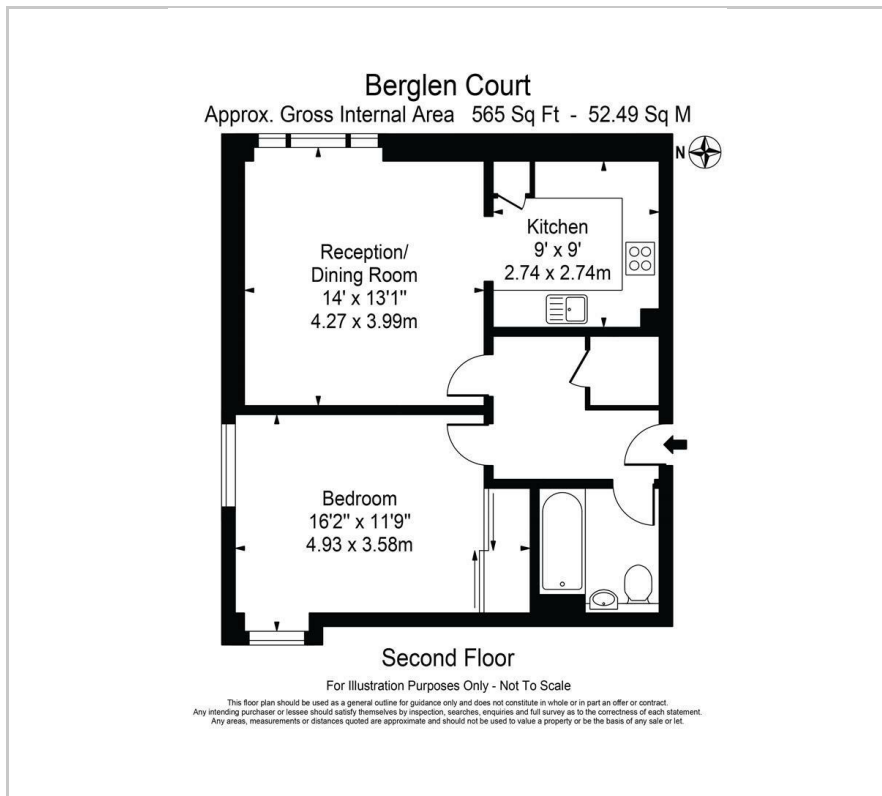

Energy Efficiency Graph

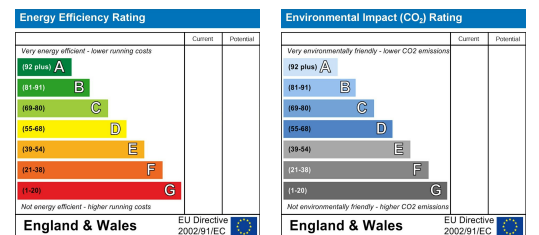

These particulars, whilst believed to be accurate are set out as a general outline only for guidance and do not constitute any part of an offer or contract. Intending purchasers should not rely on them as statements of representation of fact, but must satisfy themselves by inspection or otherwise as to their accuracy. No person in this firm's employment has the authority to make or give any representation or warranty in respect of the property.