

Franklyn James



90 Three Colt Street

, London, E14 8AP

Guide Price £400,000

Guide Price £400,000 to £425,000 - Chain Free & Share of Freehold - A unique one-bedroom ground floor flat nestled within a converted warehouse on the river. This stylish retreat boasts industrial features complemented by modern comforts.

Step into the open-plan living area, where the kitchen flows seamlessly into the cozy lounge which has direct access to its own patio, ideal for relaxation or entertaining. The tranquil bedroom offers light and airy interiors with a good sense of space.

With the added convenience of private parking and a share of freehold, this property combines security with investment potential.

Conveniently located just a short walk to Canary Wharf, the apartment benefits from excellent transport links to the city. The closest station is Westferry DLR (just a short walk away) which connects to underground stations and the Elizabeth line in minutes, making commuting a breeze. Immerse yourself in the vibrant atmosphere of Narrow Street, known for its historic charm and trendy amenities.

- SHARE OF FREEHOLD
- GARDEN / PATIO
- PRIVATE PARKING
- CHAIN FREE
- RIVER VIEWS
- WAREHOUSE CONVERSION
- IMPROVED KITCHEN & BATHROOM
- IMPROVED HEATING SYSTEM

Viewing

Please contact our Limehouse Sales Office on 02077911777 if you wish to arrange a viewing appointment for this property or require further information.

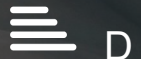

Floor Plan

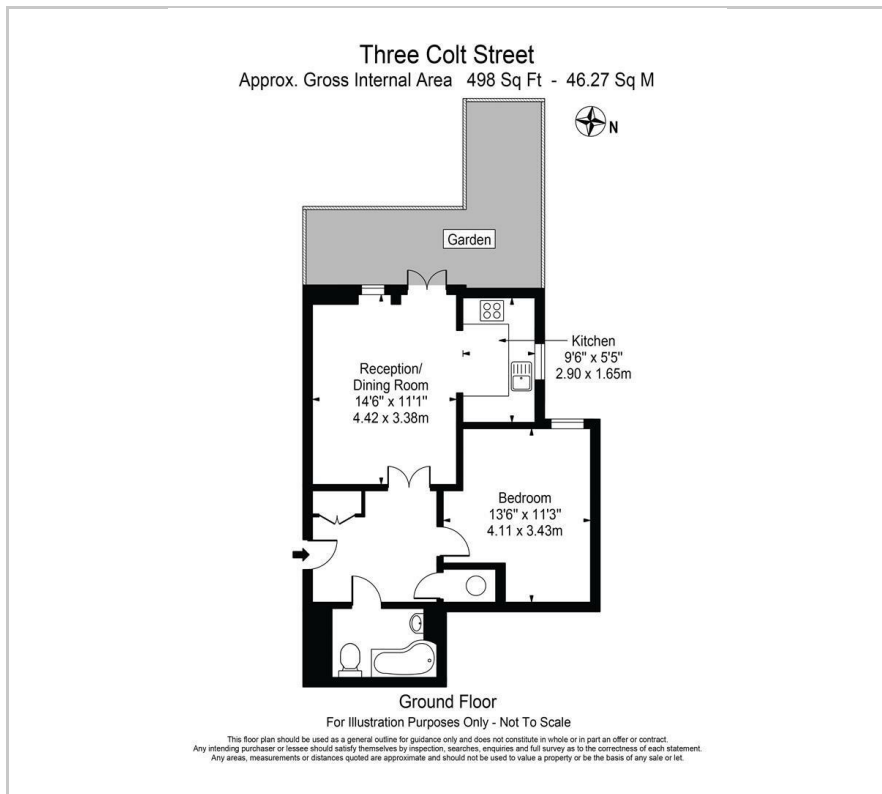

Area Map

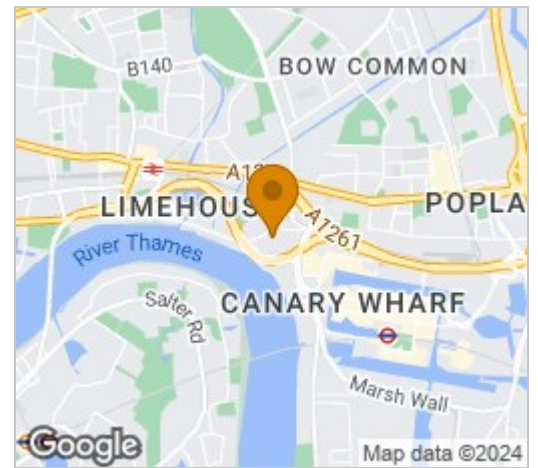

Energy Efficiency Graph

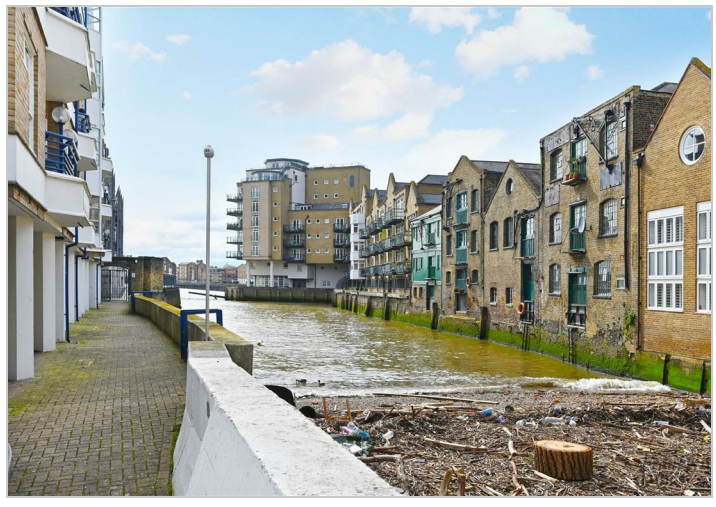
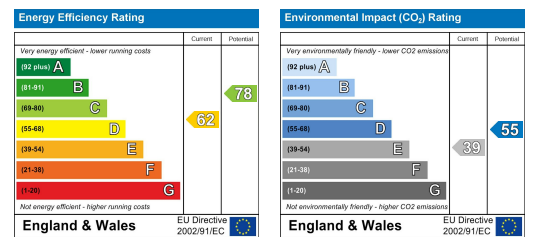

These particulars, whilst believed to be accurate are set out as a general outline only for guidance and do not constitute any part of an offer or contract. Intending purchasers should not rely on them as statements of representation of fact, but must satisfy themselves by inspection or otherwise as to their accuracy. No person in this firm's employment has the authority to make or give any representation or warranty in respect of the property.