

# Franklyn James



## 67 New Village Avenue

, London, E14 0TE

£2,200 PCM

A bright and modern two bedroom apartment located in Aberfeldy Village which has been thoughtfully designed with contemporary features.

The open-plan living room and kitchen boast solid wood flooring and a fully fitted kitchen equipped with modern appliances. The property further benefits from a spacious bedroom with built in storage, further storage in the hallway, washer/dryer, dishwasher, a modern and spacious bathroom, and a large private balcony.

Residents of this development enjoy various amenities, including a 24-hour concierge, gym, courtyard garden, work hub, and lounge facilities. The location is highly convenient, situated near Blackwall DLR and Canning Town Underground Station.

- Available NOW
- Offered furnished
- Spacious two bedroom apartment
- Two bathrooms
- Residents gym
- Concierge
- Large, private balcony
- Excellent decorative order throughout
- Moments away from to East India DLR
- Close to Canary Wharf

ewing

Please contact our Limehouse Lettings Office on 02077911777 if you wish to arrange a viewing appointment for this property or require further information.





# Floor Plan

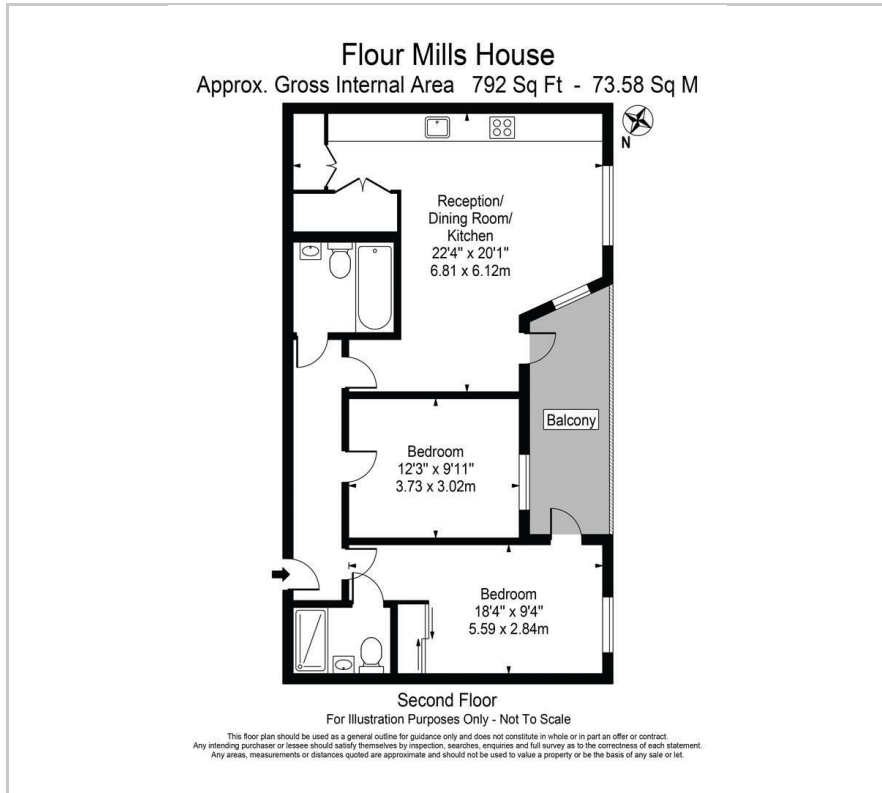

# Area Map

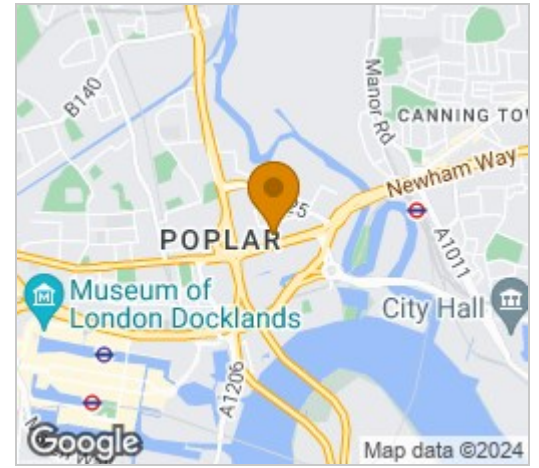

# Energy Efficiency Graph

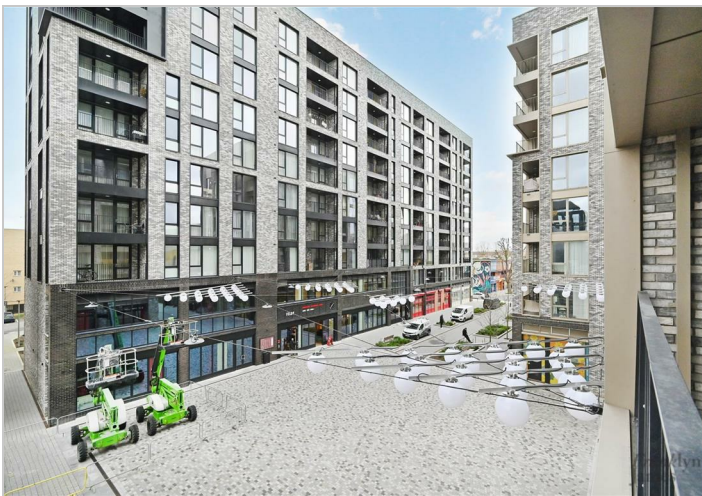
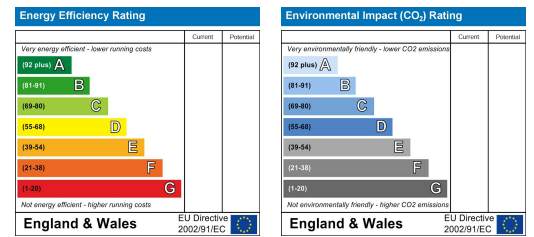

These particulars, whilst believed to be accurate are set out as a general outline only for guidance and do not constitute any part of an offer or contract. Intending purchasers should not rely on them as statements of representation of fact, but must satisfy themselves by inspection or otherwise as to their accuracy. No person in this firm's employment has the authority to make or give any representation or warranty in respect of the property.