

Franklyn James



Coral Apartments

6 Salton Square, London, E14 7GL

Offers In Excess Of £300,000

A fantastic one double bedroom apartment located within popular development. The property comprises entrance hall with video entry phone system, spacious open plan reception room leading to private balcony, fitted kitchen with built-in appliances, good size bedroom and modern bathroom.

Coral Apartments is located minutes from Limehouse DLR & C2C which provides a short commute to Canary Wharf offering a wide range of shops and restaurants. The property is also a walk away from the renowned Narrow Street, which has more restaurants and great walks along the river.

Viewing

Please contact our Limehouse Sales Office on 02077911777 if you wish to arrange a viewing appointment for this property or require further information.

- No onward chain
- One bedroom apartment
- Private balcony
- Modern development
- Close to Limehouse DLR station
- Fantastic location with a wide range of local amenities
- Moments away from Narrow Street
- Easy commute to Canary Wharf



1



1



1



B

Floor Plan

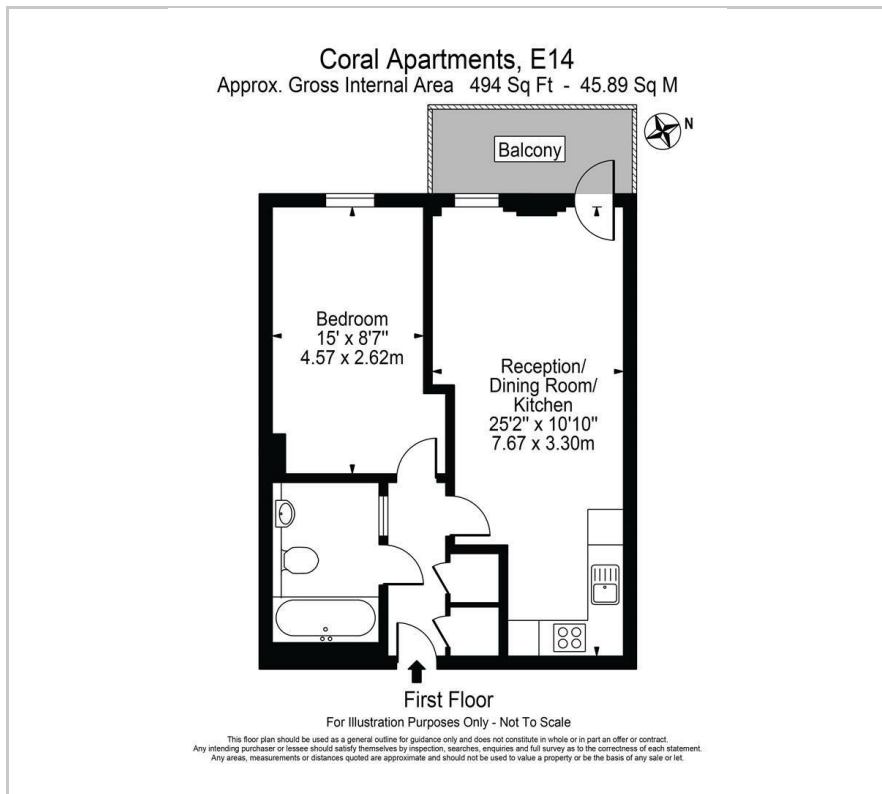

Area Map

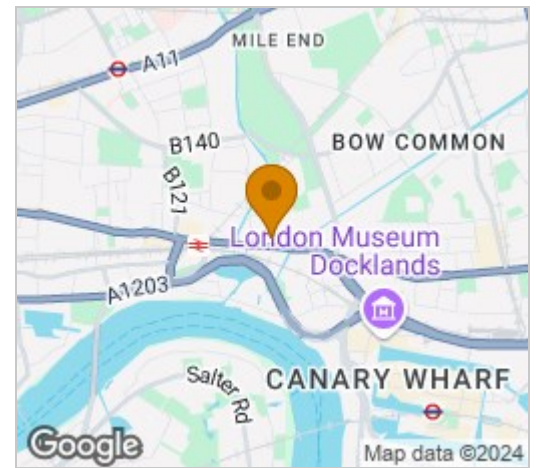

Energy Efficiency Graph

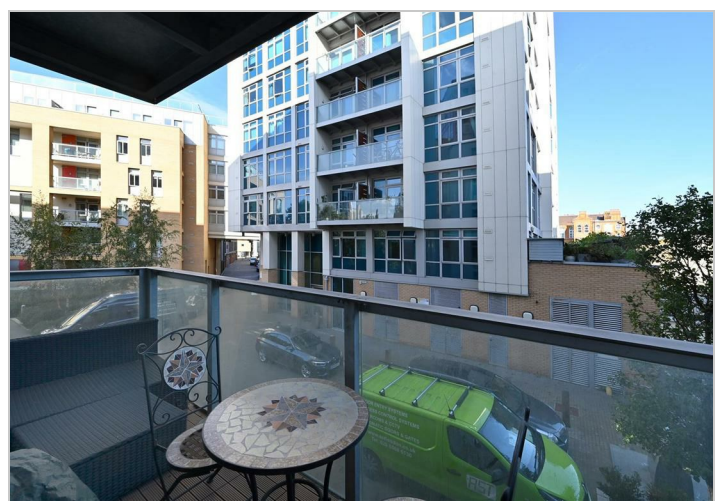
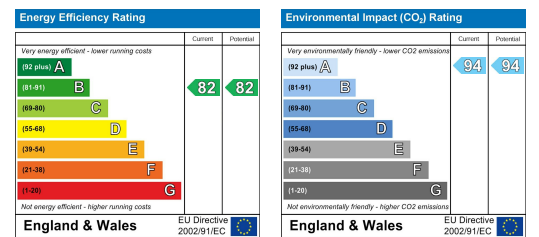

These particulars, whilst believed to be accurate are set out as a general outline only for guidance and do not constitute any part of an offer or contract. Intending purchasers should not rely on them as statements of representation of fact, but must satisfy themselves by inspection or otherwise as to their accuracy. No person in this firm's employment has the authority to make or give any representation or warranty in respect of the property.