

# Franklyn James



## Aston Street

, London, E14 7UP

£400,000

A fantastic opportunity to purchase this light and bright, one bedroom apartment with a private balcony offering great views, situated within a contemporary development of Vespucci Court in E14. This property comprises a open plan kitchen/reception with wooden flooring, a large double bedroom, a contemporary bathroom and storage space in the hallway. Being offered in excellent decorative order throughout with the added benefit of having underfloor heating, access to a Gym, cycle storage and a 24 hour concierge service.

Situated just a stone's throw away from Limehouse Station, commuting is a breeze, granting easy access to the rest of the city. Nestled near Narrow Street and Whitehorse Park, residents can enjoy leisurely strolls along the picturesque waterways or explore the array of cafes, restaurants, and shops nearby.

- 24 hour security
- Walking distance to Limehouse DLR (6 mins), Stepney Green underground (13 mins) and Mile End underground (19 mins) stations
- Open plan lounge/kitchen
- Ideal for first time buyers
- Underfloor heating
- Gym
- Quality fixtures and fittings
- Lovely views across the Park

### Viewing

Please contact our Limehouse Sales Office on 02077911777 if you wish to arrange a viewing appointment for this property or require further information.



1



1



1

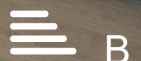

B

# Floor Plan

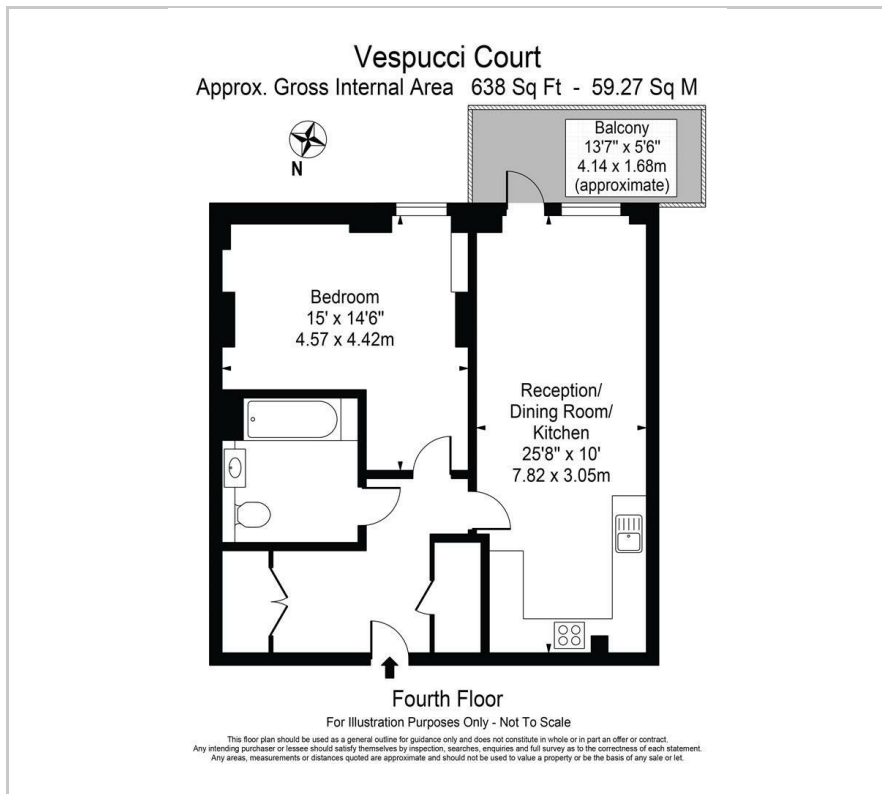

# Area Map

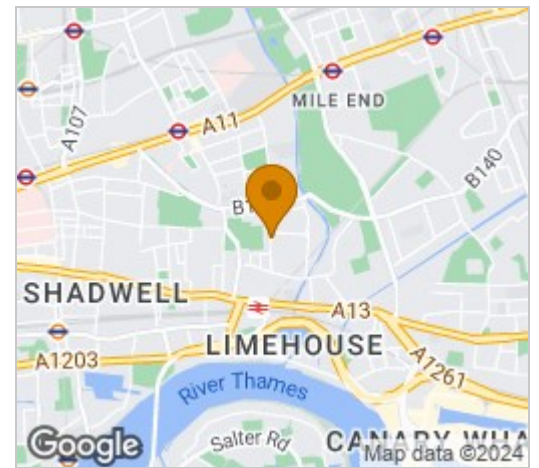

# Energy Efficiency Graph

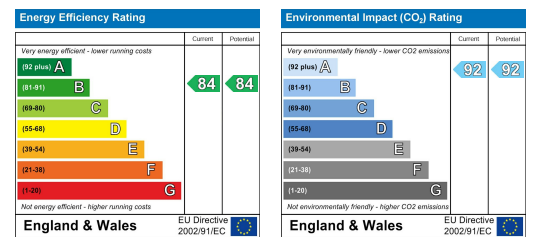

These particulars, whilst believed to be accurate are set out as a general outline only for guidance and do not constitute any part of an offer or contract. Intending purchasers should not rely on them as statements of representation of fact, but must satisfy themselves by inspection or otherwise as to their accuracy. No person in this firm's employment has the authority to make or give any representation or warranty in respect of the property.