

Franklyn James



Commercial Road

, London, E14 7LF

£535,000

Situated in the heart of Limehouse E14, this charming split-level conversion offers period elegance and contemporary comfort. Boasting two bedrooms, one bathroom, and a private garden. Upon entering, you are greeted by a bright and airy interior flooded with natural light, thanks to its upper floor positioning. The property benefits from two double bedrooms, a sleek bathroom and the adjoining kitchen is thoughtfully designed with modern conveniences, ensuring both functionality and style.

Being a short walk to the renowned Narrow Street you will find a variety of riverside restaurants, pubs, shops and cafes such as Bread Street Kitchen, The Grapes and La Figa can be found along Narrow Street. Further along the Thames Footpath to the West you will find Wapping. With its cobbled streets, dockland history and marina (St Katharine Docks), it is a quaint and unique part of London.

Limehouse DLR is just moments away providing convenient transport links to Bank DLR and Canary Wharf. The DLR also connects you to Stratford International, and the C2C train in Limehouse takes you to the Essex coast or Fenchurch Street.

- 2 double bedrooms
- Private garden
- Prime location
- Many nearby amenities
- 0.2m to Limehouse DLR Station
- Transportation links into the city & Essex
- Period conversion
- No onward chain

Viewing

Please contact our Limehouse Sales Office on 02077911777 if you wish to arrange a viewing appointment for this property or require further information.

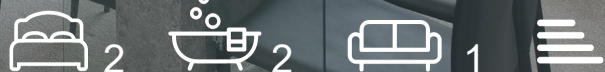

Floor Plan

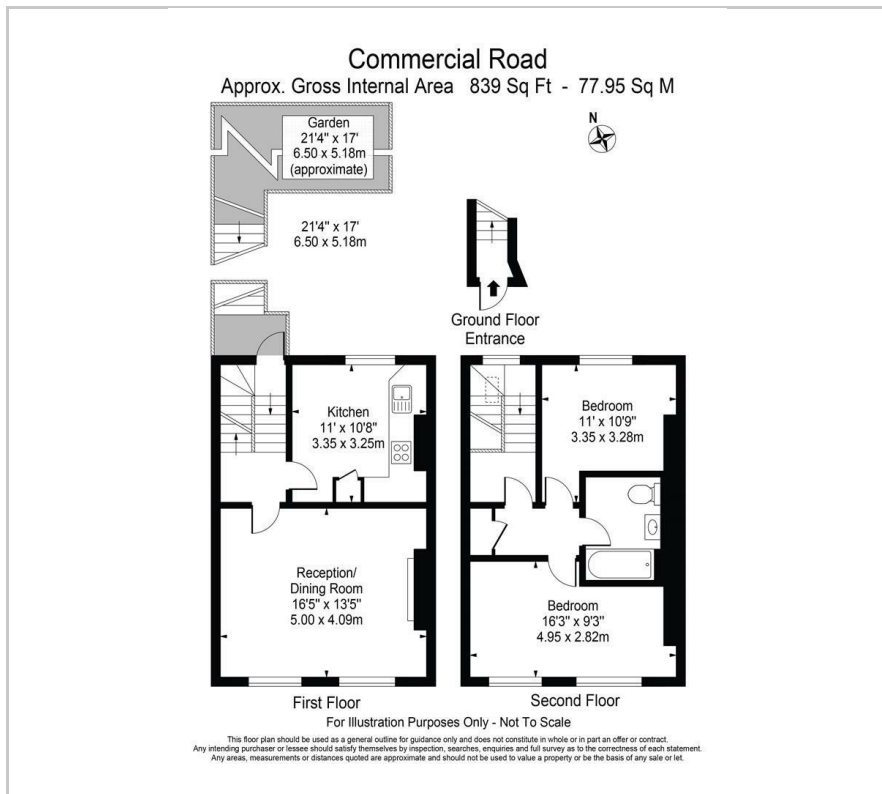

Area Map



Energy Efficiency Graph

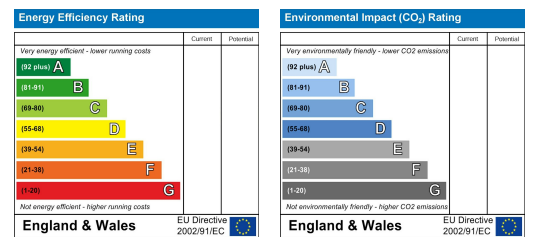

These particulars, whilst believed to be accurate are set out as a general outline only for guidance and do not constitute any part of an offer or contract. Intending purchasers should not rely on them as statements of representation of fact, but must satisfy themselves by inspection or otherwise as to their accuracy. No person in this firm's employment has the authority to make or give any representation or warranty in respect of the property.