

# Franklyn James



## Branch Road

Limehouse, London, E14 7JT

Asking Price £475,000

This beautiful and sunny one bedroom apartment is situated in a sought-after development adjacent to Limehouse Marina. The property has been carefully refurbished throughout and boasts a spacious reception room that opens up to a private balcony with stunning views of the marina, a fully equipped modern kitchen, a comfortable double bedroom with ample storage space, a recently updated modern shower room, and a secure allocated parking space.

Residents of Medland House can also enjoy the convenience of a 24-hour concierge service and the proximity of Limehouse DLR station, which is only a few seconds away. The development is well maintained throughout and Option for Hyperoptic fibre broadband is available.

- Spacious one bedroom apartment situated on the 3rd floor
- Refurbished throughout
- Modern kitchen with integrated appliances
- Large balcony with views over the marina
- Secure, underground parking
- Short walk to Limehouse DLR
- Option to include furniture in purchase.
- Well maintained development
- EWS1 compliant
- Chain free

Please contact our Limehouse Sales Office on 02077911777 if you wish to arrange a viewing appointment for this property or require further information.





# Floor Plan

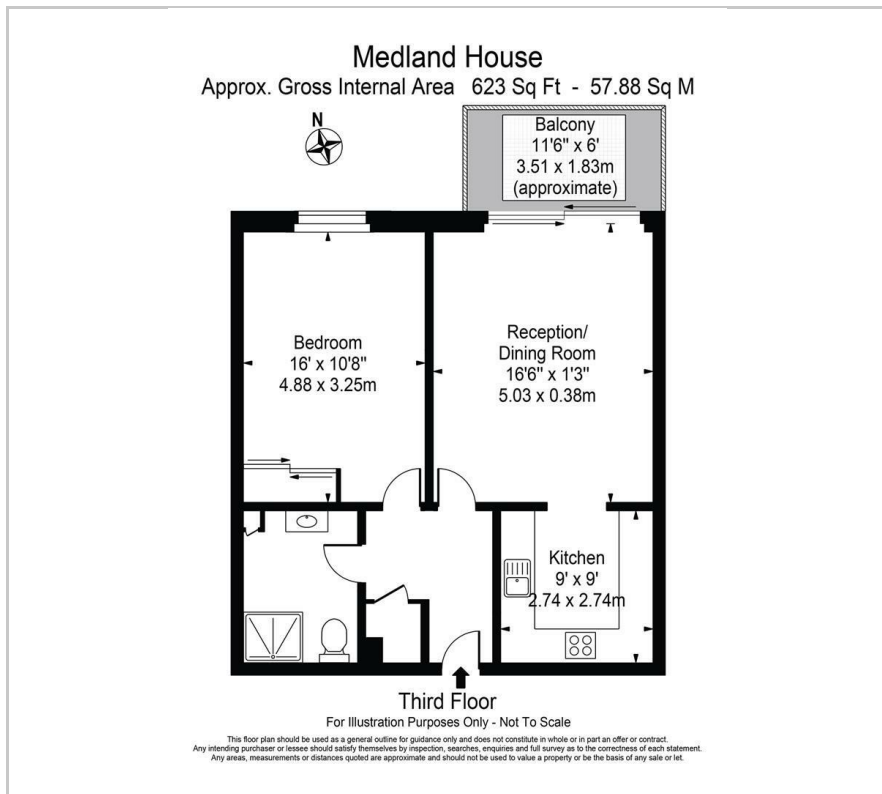

# Area Map



# Energy Efficiency Graph

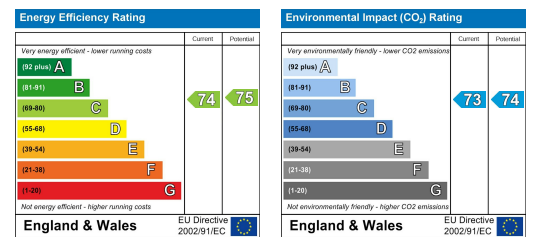

These particulars, whilst believed to be accurate are set out as a general outline only for guidance and do not constitute any part of an offer or contract. Intending purchasers should not rely on them as statements of representation of fact, but must satisfy themselves by inspection or otherwise as to their accuracy. No person in this firm's employment has the authority to make or give any representation or warranty in respect of the property.