

Franklyn James



Windsor Court

18 Mostyn Grove, Bow, E3 2LL

£350,000

This fantastic one-bedroom apartment is situated in the highly desirable So Bow development. It boasts beautiful hardwood floors, a top-notch kitchen, and a luxurious bathroom. With a built-in wardrobe and plenty of storage space, it's practical and stylish. Plus, tenants can enjoy a spacious private balcony. The building offers added perks like a 24-hour concierge and communal gardens. Conveniently located near Mile End station, Bow Road station, and Bow Church DLR, it's easily accessible. This property in Windsor Court is a wonderful choice, blending comfort and convenience, ideal for both investors and first-time buyers looking for modern living.

- One bedroom apartment
- Luxury bathroom
- High specification kitchen
- Ample storage
- Private balcony
- 24 hour concierge & communal garden

Viewing

Please contact our Limehouse Lettings Office on 02077911777 if you wish to arrange a viewing appointment for this property or require further information.



1



1



1



B

Floor Plan

Area Map

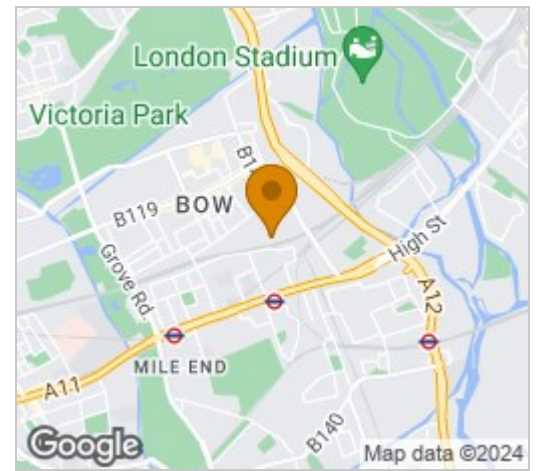
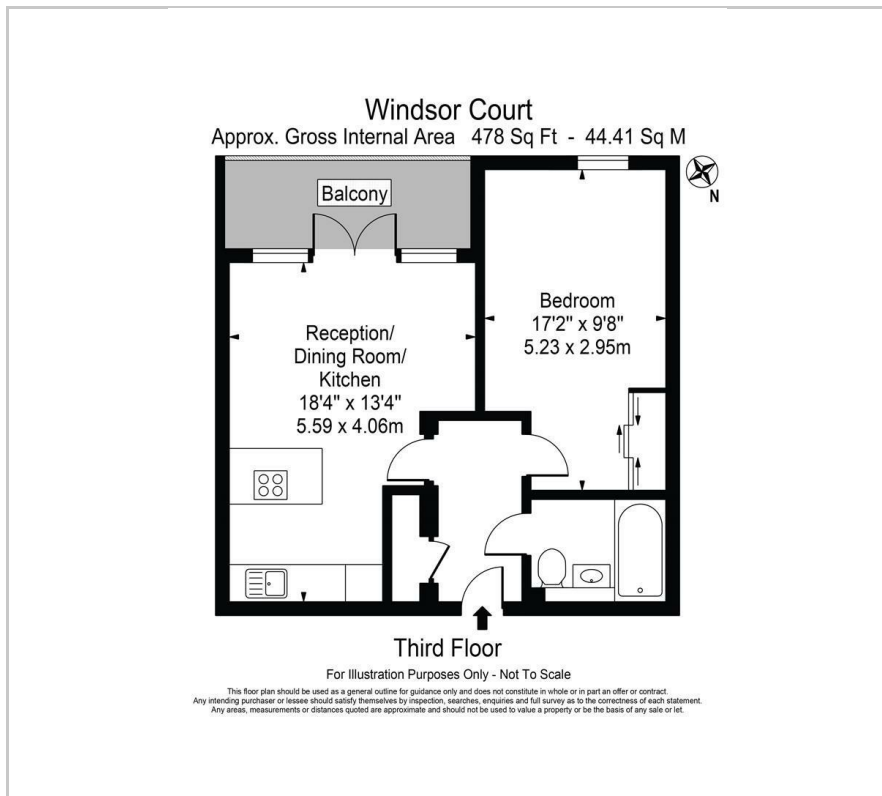

Energy Efficiency Graph

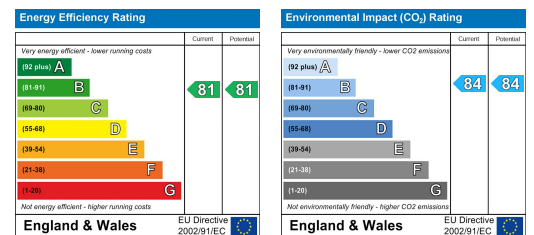

These particulars, whilst believed to be accurate are set out as a general outline only for guidance and do not constitute any part of an offer or contract. Intending purchasers should not rely on them as statements of representation of fact, but must satisfy themselves by inspection or otherwise as to their accuracy. No person in this firm's employment has the authority to make or give any representation or warranty in respect of the property.