

Franklyn James



7, Rolling Mills Mews

, London, E14 7FQ

£525,000

Offered Chain Free - A stunning 2-bedroom, 2-bathroom apartment is a waterfront haven, boasting a breathtaking view of the marina that will leave you mesmerized. The open-plan living space is designed for modern comfort and versatility, with ample natural light streaming in through large windows, creating an inviting and spacious atmosphere. This apartment offers both comfort and luxury. It's not just a home; it's a lifestyle with two well-appointed bedrooms and two stylish bathrooms.

Located in Limehouse, you'll have easy access to local amenities, parks, and transportation options, making this apartment an ideal choice for those seeking the best of city living. Make this your new home in Limehouse and experience the dynamic urban lifestyle you've been looking for.

- Private balcony
- 0.2 miles from Limehouse station
- Views of Canary Wharf, Limehouse Basin & City
- Marina Side Development
- 200 year lease from 2013
- 754sq.ft Living Space
- Communal Roof Garden
- Residents outdoor terrace located on the fourth floor

Viewing

Please contact our Limehouse Sales Office on 02077911777 if you wish to arrange a viewing appointment for this property or require further information.



Floor Plan

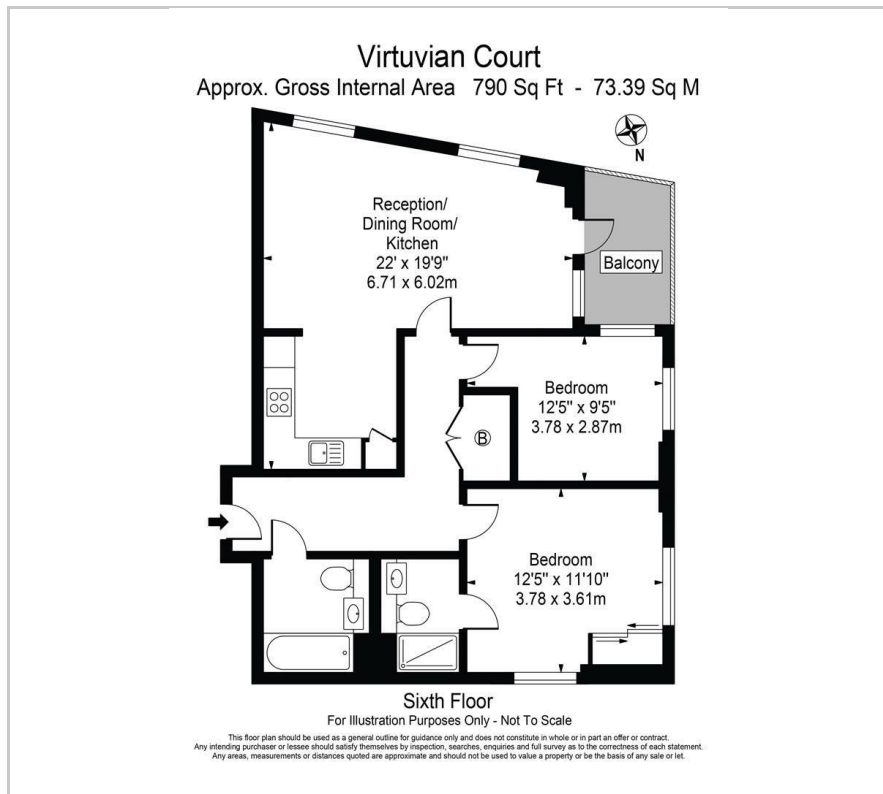

Area Map

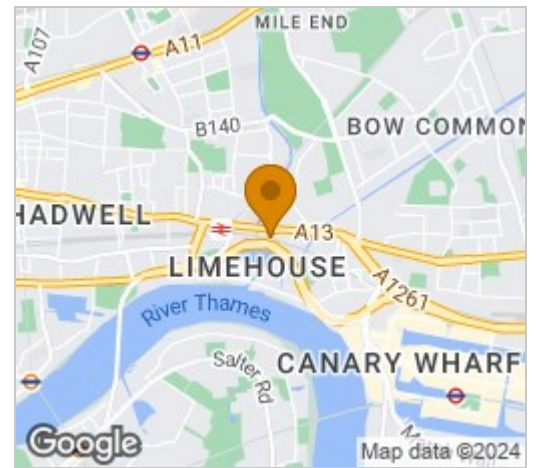

Energy Efficiency Graph

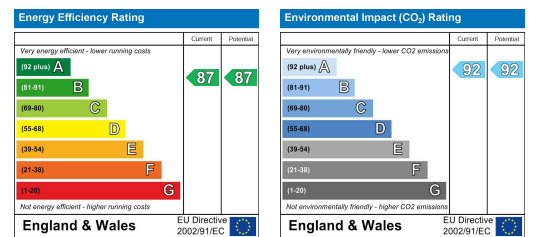

These particulars, whilst believed to be accurate are set out as a general outline only for guidance and do not constitute any part of an offer or contract. Intending purchasers should not rely on them as statements of representation of fact, but must satisfy themselves by inspection or otherwise as to their accuracy. No person in this firm's employment has the authority to make or give any representation or warranty in respect of the property.