



**Shirehampton - £350,000**

3 bed semi-detached house

22 The Ridge, BS11 0DZ





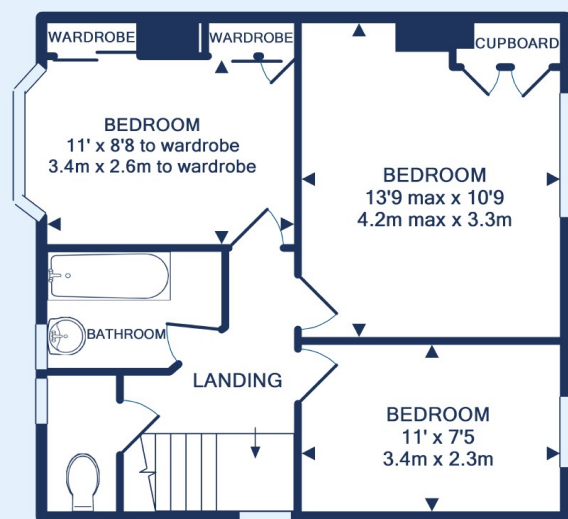
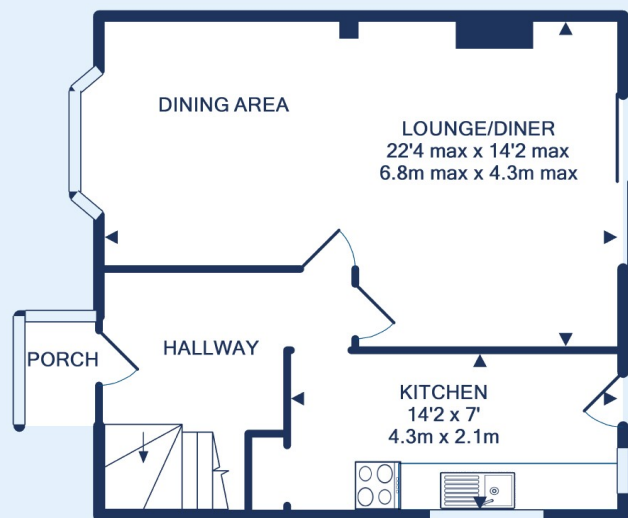

Made with Metropix ©2021



Being sold with no chain, this semi detached home is elevated from the road and has outstanding views over Shirehampton and out towards North Somerset.

The accommodation has a light and airy feel throughout thanks to its open reception rooms and large windows that let in plenty of natural light.

You enter into the spacious hallway and from here you can access the living spaces and the kitchen.

The lounge and dining room have been opened up to link both these rooms together. The dining area is at the front of the house and this has a bay window and benefits from the great views. The lounge is at the back and has large patio doors that open to the garden.

The kitchen has a pantry space under the stairs and there is also room in here for a small table. The garden can also be accessed from here.

Upstairs, there are three good sized bedrooms, a bathroom and a separate WC.

Two of the bedrooms have fitted wardrobes.

The front bedroom, like the dining space below, has a bay window but has even better views being on the floor above !

Both the back bedrooms look over the back garden.

Outside, the garden has been lovingly cared for and has plenty of mature shrubs and trees.

It measures approximately 75ft and has a garage at the rear.

There is plenty of space at the side of the house for storage sheds.

The Ridge runs parallel to the High Street, so the village with all its shops and amenities is a short walk away.

The local transport links are ideal as Shirehampton Train Station, which links to Clifton Down and Temple Meads is within walking distance, as is the Portway Park & Ride bus service.



## Shirehampton Office

14-16 High Street, Shirehampton, Bristol,  
BS11 0DP

Call: 0117 9380611

Mail:

Search: [oceanhome.co.uk](https://oceanhome.co.uk)

References to the Tenure of a Property are based on information supplied by the Seller. The Agent has not had sight of the title documents. Lease details, service ground rent (where applicable) are given as a guide only and should be checked and confirmed by your solicitor prior to exchange of contracts.