



Shirehampton - £285,000

3 bed end of terrace house

27 Bradley Avenue, BS11 9SL



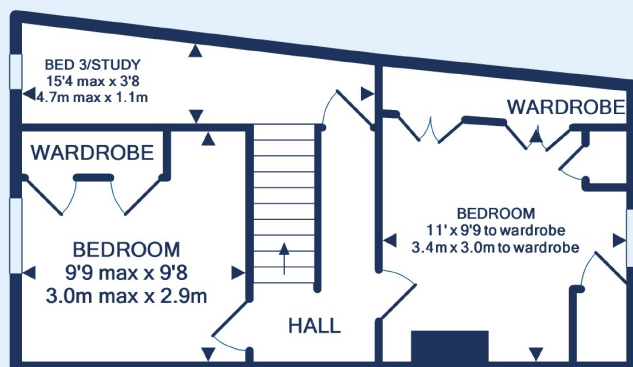
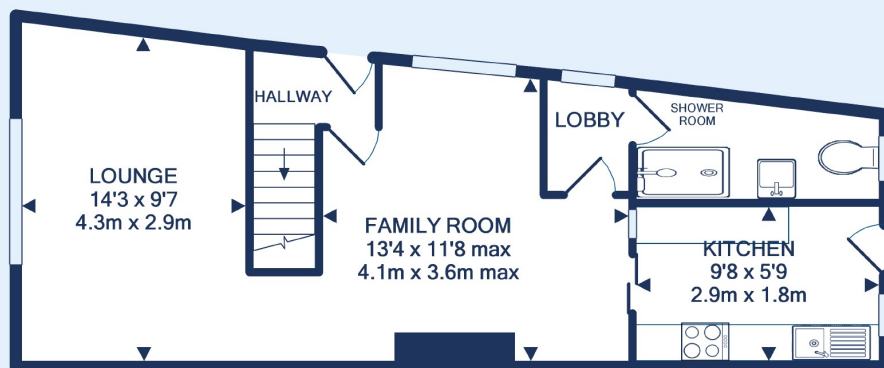

Made with Metropix ©2021



This stone fronted end of terrace period home in the heart of the village has a pretty courtyard garden and is being sold with no chain.

Bradley Avenue is a really convenient location as all the amenities including shops, cafes, schools and transport links are minutes away.

The accommodation on the ground floor has been opened up to create a more sociable living space.

The lounge area is at the front of the house, whilst the family room/dining area is next to the kitchen.

Many years ago, the house was extended on the ground floor and this extension is home to the kitchen and the shower room.

The kitchen has modern white handleless units with a grey work surface and there is an integral oven & hob. The back garden is accessed from here.

Upstairs there are two double bedrooms, both of which have fitted units.

There is a small room that makes an ideal study or could be a bedroom for a child under 10.

Outside there is a really pretty courtyard garden that has plenty of established plants and shrubs that provide plenty of colour.

There is a pedestrian side gate which is really useful for garden waste or storing bikes etc.

The house has gas central heating, double glazing and is being sold with no chain.



Shirehampton Office

14-16 High Street, Shirehampton, Bristol,
BS11 0DP

Call: 0117 9380611

Mail:

Search: oceanhome.co.uk

References to the Tenure of a Property are based on information supplied by the Seller. The Agent has not had sight of the title documents. Lease details, service ground rent (where applicable) are given as a guide only and should be checked and confirmed by your solicitor prior to exchange of contracts.