



Coombe Dingle - Best offers around £200,000

1 bed bungalow

61b Arbutus Drive, BS9 2PW



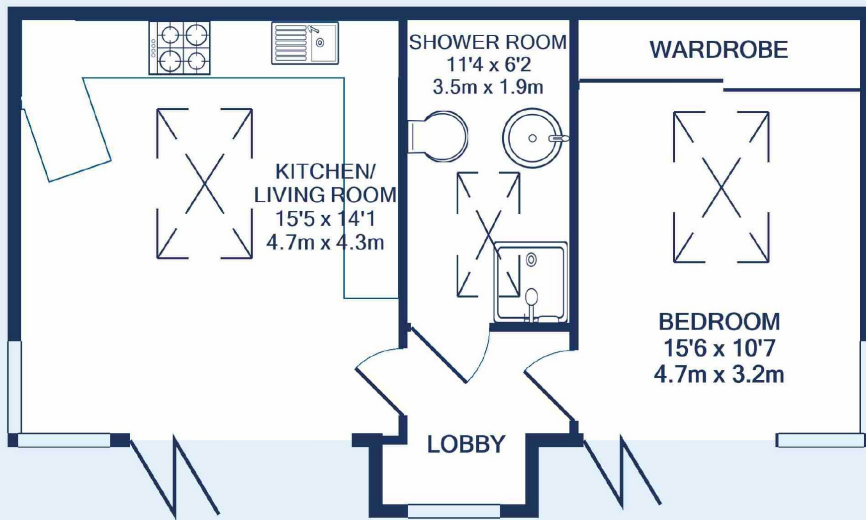

TOTAL APPROX. FLOOR AREA 487 SQ.FT. (45.3 SQ.M.)
Made with Metropix ©2020

****Cash buyers only ****

An immaculate and extremely unique one bedroom detached bungalow in a beautiful location in the leafy suburb of Coombe Dingle which offers convenient access to both Kingweston and Blaise estates.

The property was built approximately 5 years ago it is highly efficient with its own solar panels and water recycling system. The accommodation is modern and striking consisting open plan lounge/kitchen/diner, shower room, boiler room and double bedroom with built in wardrobes.

Externally there is an attractive alfresco deck/patio area accessed from both the bedroom and the living area via bi fold doors, there is a separate area on the level above laid to astroturf with private bike storage.

There is underfloor heating throughout and air conditioning as well as its own hot tub and outdoor shower area.

Offered with no chain.



Westbury on Trym Office

73 Westbury Hill, Westbury-on-Trym,
Bristol, BS9 3AD

Call: 0117 9621973

Mail: westburysales@oceanhome.co.uk

Search: oceanhome.co.uk

References to the Tenure of a Property are based on information supplied by the Seller. The Agent has not had sight of the title documents. Lease details, service ground rent (where applicable) are given as a guide only and should be checked and confirmed by your solicitor prior to exchange of contracts.