



35 Churnet Close  
Leek



Estate Agents. Valuers. Auctioneers. Chartered Surveyors  
Part of the Bagshaws Partnership

## 35 Churnet Close

Leek  
ST13 7JN

A pleasantly situated semi-detached bungalow located in a well established residential area in Cheddleton in a quiet cul-de-sac position.

The property provides two bedroom accommodation which is in need of a little updating but has enormous potential.

The property enjoys the benefits of gas central heating, hardwood double glazing

Externally gardens to the front and rear and has off road parking facilities.

Offered with No upward chain



£167,950



2



1



1



D



acre(s)



Leek - 01538 383344



leek@buryandhilton.co.uk





# General Information

**Entrance hall**  
Radiator. Carpet. Store off.

**Lounge**  
Fitted gas fire. Radiator. Fitted carpet. French windows leading to rear garden.

**Kitchen**  
Range of units consisting of sink unit, base units, working surfaces and wall cupboards. Plumbing for automatic washing machine. Gas central heating boiler.

**Bedroom one**  
Range of fitted wardrobes. Radiator. Fitted carpet.

**Bedroom two**  
Radiator. Fitted carpet.

**Bathroom**  
Partly tiled with suite comprising bath with electric shower over. Double vanity wash basins. WC. Radiator.

**Outside**  
Driveway provides off road parking facilities and leads to a detached sectional garage. Gardens to the front and rear.

**Services**  
All mains services connected  
Gas central heating  
Hardwood double glazing

**Viewing**  
By prior appointment via Leek office on 01538 383344

## GROUND FLOOR

APPROX. 55.8 SQ. METRES (600.6 SQ. FEET)

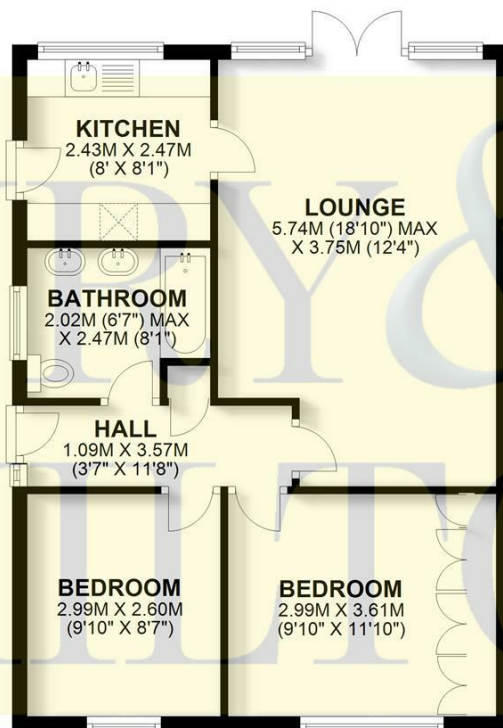

TOTAL AREA: APPROX. 55.8 SQ. METRES (600.6 SQ. FEET)

Plan produced by [www.firstpropertyservices.co.uk](http://www.firstpropertyservices.co.uk). We accept no responsibility for any mistake or inaccuracy contained within the floorplan. The floorplan is provided as a guide and should be taken as an illustration only. The measurements, contents and positioning are approximations only and provided as a guidance tool and not an exact replication of the property.  
Plan produced using PlanUp.

## Agents Notes

Bury & Hilton have made every reasonable effort to ensure these details offer an accurate and fair description of the property. The particulars are produced in good faith, for guidance only and do not constitute or form an offer or part of the contract for sale. Bury & Hilton and their employees are not authorised to give any warranties or representations in relation to the sale and give notice that all plans, measurements, distances, areas and any other details referred to are approximate and based on information available at the time of printing.



6 Market Street, Leek, Staffordshire, ST13 6HZ

T: 01538 383344

E: [leek@buryandhilton.co.uk](mailto:leek@buryandhilton.co.uk)

[www.buryandhilton.co.uk](http://www.buryandhilton.co.uk)

Part of the Bagshaws Partnership



## Offices in:

Ashbourne	01335 342201
Bakewell	01629 812777
Buxton	01298 27524
Leek	01538 383344
Penkridge	01785 716600
Uttoxeter	01889 562811