



Clover Grove

Leekbrook



Estate Agents. Valuers. Auctioneers. Chartered Surveyors
Part of the Bagshaws Partnership

70 Clover Grove

Leekbrook
Staffordshire
ST13 7AS

- ◆ A one bedroom second floor apartment located on the popular Wardle Gardens development.
 - ◆ Situated on a modern development on the outskirts of Leek town centre, within easy reach of Cheddleton, the location offers access to a variety of local amenities, schools and commuter links.
 - ◆ The well presented accommodation benefits from Upvc double glazing and gas fired central heating.
 - ◆ The property briefly comprises: Entrance Hall, Living Room with Kitchen and Dining Area, Double Bedroom and Bathroom.
 - ◆ Allocated parking space and access to communal garden areas.
- * The property may be of interest to landlords or first time buyers looking to get on the housing ladder.
* Viewing highly recommended.

Offers in the region of : £95,000



1



1



1



B

Council Tax
Band

A



Leek Office - 01538 383344



leek@buryandhilton.co.uk



GROUND FLOOR
APPROX. 45.5 SQ. METRES (489.5 SQ. FEET)

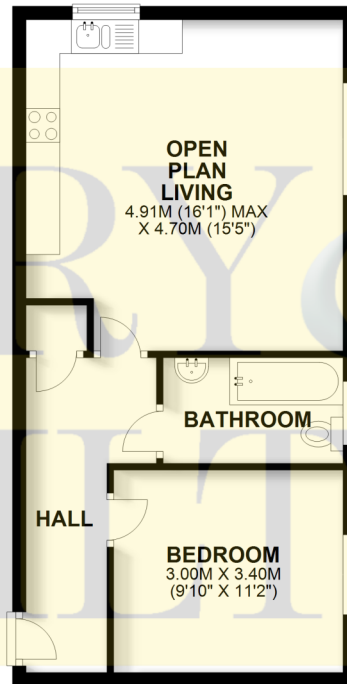

TOTAL AREA: APPROX. 45.5 SQ. METRES (489.5 SQ. FEET)

Plan produced by www.firstpropertyservices.co.uk. We accept no responsibility for any mistake or inaccuracy contained within the floorplan. The floorplan is provided as a guide and should be taken as an illustration only. The measurements, contents and positioning are approximations only and provided as a guidance tool and not an exact replication of the property.
Plan produced using PlanUp.

Agents Notes

Bagshaws LLP have made every reasonable effort to ensure these details offer an accurate and fair description of the property but give notice that all measurements, distances and areas referred to are approximate and based on information available at the time of printing. These details are for guidance only and do not constitute part of the contract for sale. Bagshaws LLP and their employees are not authorised to give any warranties or representations in relation to the sale.



6 Market Street, Leek, Staffordshire, ST13 6HZ

T : 01538 383344

E : leek@buryandhilton.co.uk

www.buryandhilton.co.uk

Part of the Bagshaws Partnership



Offices in:

Ashbourne	01335 342201
Bakewell	01629 812777
Buxton	01298 27524
Leek	01538 383344
Penkridge	01785 716600
Uttoxeter	01889 562811

arla | [propertymark](http://propertymark.co.uk)



OnTheMarket.com

[rightmove](http://rightmove.co.uk)

[Zoopla](http://Zoopla.co.uk)