



Britannia Street

Leek



Estate Agents. Valuers. Auctioneers. Chartered Surveyors

Part of the Bagshaws Partnership

16 Britannia Street

Leek
ST13 5EL

- ◆ A two bedroom mid terrace situated in a highly convenient position for the town centre.
- ◆ The property benefits from double glazing and gas fired central heating.
- ◆ Accommodation comprises: Lounge, Kitchen and Bathroom to the ground floor. Two Bedrooms to the first floor.
- ◆ Yard area to the rear aspect.
- ◆ The property may be of interest to landlords or first time buyers.

* Offered For Sale with No Upward Chain involved.

Offers in the region of : £115,000



2



1



1



D



Leek Office - 01538 383344



leek@buryandhilton.co.uk





Accommodation

Entrance Area

Access to:

Living Room / Dining Room 21'4 x 11'6 (6.50m x 3.51m)

Radiator x 2. Gas fire. Storage cupboard. Access to cellar.

Kitchen 10'1 x 6'7 (3.07m x 2.01m)

Wall and base units. Stainless steel sink unit with drainer. Gas cooker point. Plumbing point. Radiator. Tiled walls. Tiled floor. Rear door.

Wet Room 5'5 x 5'9 (1.65m x 1.75m)

Shower area. W.c. Wash basin. Radiator. Tiled walls.

Landing Area

Loft access.

Bedroom 11'3 x 11'6 (3.43m x 3.51m)

Radiator.

Bedroom 10'5 x 9'5 (3.18m x 2.87m)

Radiator.

Outside

Rear yard area.

Viewing

By prior appointment via Bury & Hilton Leek office 01538 383344

Council Tax Band –A

Agents Note

Bury & Hilton have made every reasonable effort to ensure these details offer an accurate and fair description of the property. The particulars are produced in good faith, for guidance only and do not constitute or form an offer or part of the contract for sale. Bury & Hilton and their employees are not authorised to give any warranties or representations in relation to the sale and give notice that all plans, measurements, distances, areas and any other details referred to are approximate and based on information available at the time of printing.

GROUND FLOOR
APPROX. 36.7 SQ. METRES (394.8 SQ. FEET)

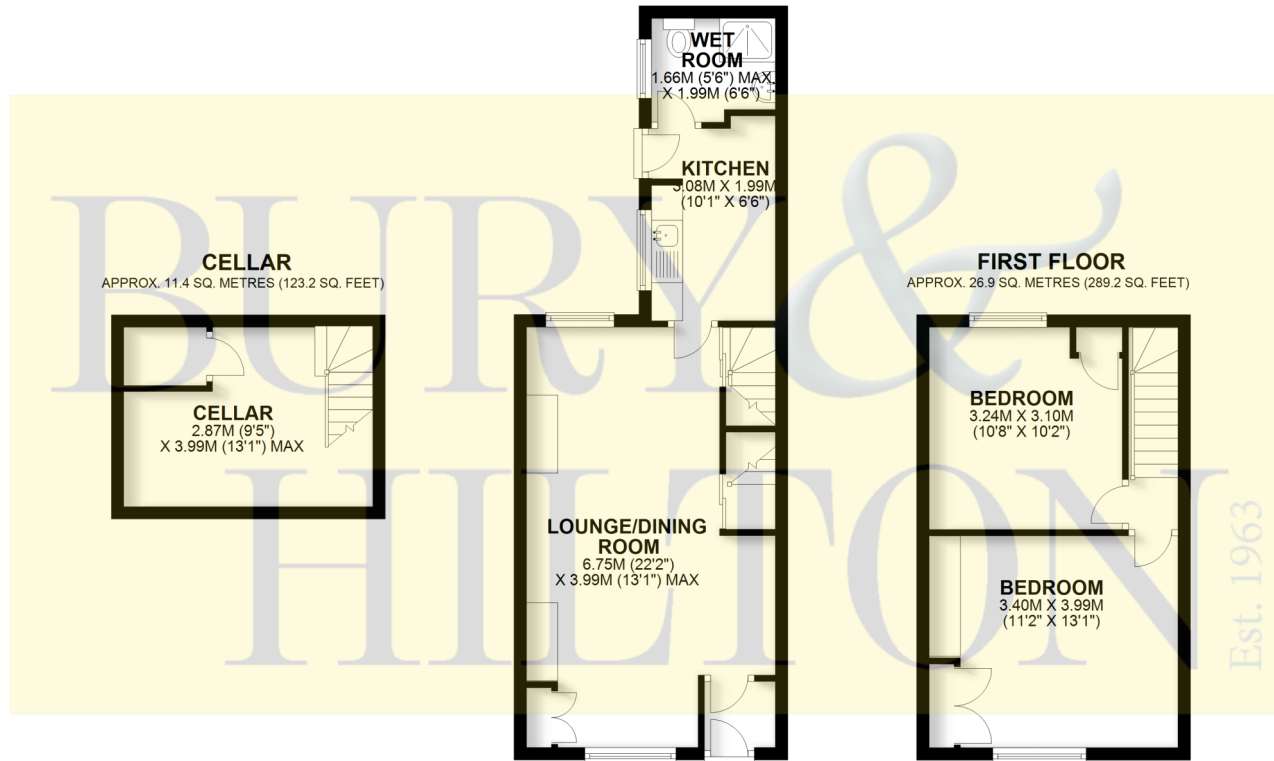

TOTAL AREA: APPROX. 75.0 SQ. METRES (807.1 SQ. FEET)

Plan produced by www.firstpropertyservices.co.uk. We accept no responsibility for any mistake or inaccuracy contained within the floorplan. The floorplan is provided as a guide and should be taken as an illustration only. The measurements, contents and positioning are approximations only and provided as a guidance tool and not an exact replication of the property.
Plan produced using PlanUp.



6 Market Street, Leek, Staffordshire, ST13 6HZ

T : 01538 383344

E : leek@buryandhilton.co.uk

www.buryandhilton.co.uk

Part of the Bagshaws Partnership

Offices in:

| | |
|-----------|--------------|
| Ashbourne | 01335 342201 |
| Bakewell | 01629 812777 |
| Buxton | 01298 27524 |
| Leek | 01538 383344 |
| Penkridge | 01785 716600 |
| Uttoxeter | 01889 562811 |

arla | [propertymark](http://propertymark.co.uk)



OnTheMarket.com

[rightmove](http://rightmove.co.uk)

[Zoopla](http://Zoopla.co.uk)