



15 Hazel Grove,  
Leek



Estate Agents. Valuers. Auctioneers. Chartered Surveyors  
Part of the Bagshaws Partnership

## 15 Hazel Grove,

Leek  
Staffordshire  
ST13 8UU

- \* An opportunity to purchase a two bedroom detached bungalow situated in the West End of Leek on a small cul-de-sac.
- \* The property does require some internal decoration and presents the opportunity for the buyer to put their own stamp on it.
- \* The bungalows accommodation briefly comprises: Entrance Hall, Living Room, Kitchen, Inner Hallway, Two Bedrooms, Shower Room and Conservatory.
- \* A driveway provides ample off road parking and leads to a detached garage.
- \* Benefiting from double glazing and gas fired central heating.
- \* Gardens are located to the front and rear.
- \* Not overlooked from the rear aspect with good views over the surrounding area.
- \* The property is offered For Sale with No Upward Chain involved.



Offers In The Region Of £219,950



2



1



1



D



0.00  
acre(s)



Leek - 01538 383344



leek@buryandhilton.co.uk





# General Information

## Entrance Hall

Storage cupboard off.

## Kitchen

Wall and base units. Stainless steel sink unit with drainer and mixer tap. Rear door. Plumbing point. Cooker point.

## Living Room

Bay window. Radiator. Gas fire. Coving.

## Inner Hall

Radiator. Loft access.

## Bedroom

Radiator.

## Bedroom

Radiator.

## Conservatory

Radiator. Tiled floor.

## Shower Room

Shower cubicle. W.c. Wash basin. Radiator.

## Outside

A driveway provides ample off road parking and leads to a detached garage. Gardens are located to the front and rear. Excellent views towards Ladderedge.



## GROUND FLOOR

APPROX. 58.7 SQ. METRES (631.7 SQ. FEET)

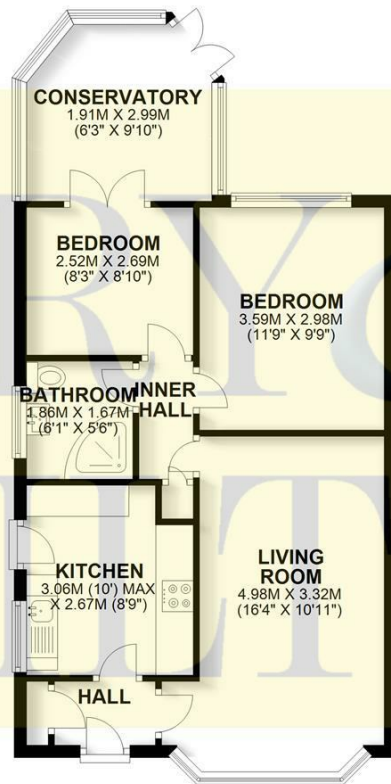

TOTAL AREA: APPROX. 58.7 SQ. METRES (631.7 SQ. FEET)

Plan produced by [www.firstpropertyservices.co.uk](http://www.firstpropertyservices.co.uk). We accept no responsibility for any mistake or inaccuracy contained within the floorplan. The floorplan is provided as a guide and should be taken as an illustration only. The measurements, contents and positioning are approximations only and provided as a guidance tool and not an exact replication of the property.  
Plan produced using PlanUp.

## Agents Notes

Bury & Hilton have made every reasonable effort to ensure these details offer an accurate and fair description of the property. The particulars are produced in good faith, for guidance only and do not constitute or form an offer or part of the contract for sale. Bury & Hilton and their employees are not authorised to give any warranties or representations in relation to the sale and give notice that all plans, measurements, distances, areas and any other details referred to are approximate and based on information available at the time of printing.



6 Market Street, Leek, Staffordshire, ST13 6HZ

T: 01538 383344

E: [leek@buryandhilton.co.uk](mailto:leek@buryandhilton.co.uk)

[www.buryandhilton.co.uk](http://www.buryandhilton.co.uk)

Part of the Bagshaws Partnership



## Offices in:

Ashbourne	01335 342201
Bakewell	01629 812777
Buxton	01298 27524
Leek	01538 383344
Penkridge	01785 716600
Uttoxeter	01889 562811

arla | [propertymark](http://propertymark.co.uk)

